



Hillary Drive, TW7

£1,625 Per calendar month

A brand newly refurbished one bedroom apartment offering stylish interiors, spacious living accommodation, modern kitchen and bathroom, generous bedroom, communal grounds, and included parking. Ideally located close to local amenities and transport links, perfect for comfortable contemporary living.

Set within a quiet gated development off Twickenham Road, this property is approximately 0.80 miles from Twickenham Station, close to local bus routes, Redlees Park, and excellent links to Richmond, St Margarets, and Central London.

Features

- Brand Newly Refurbished
- One Bedroom
- Spacious Reception Room
- Modern Kitchen
- Resident Parking
- Gated Development



Hillary Drive, TW7

This brand newly refurbished one bedroom apartment offers bright, contemporary living throughout, featuring a spacious reception room, stylish modern kitchen with integrated appliances, neutral décor, light, and smart finishes creating a space ideal for couples.

The generously sized bedroom benefits from soft carpeting, attractive feature wallpaper, and fitted storage, while the beautifully finished bathroom includes elegant tiling, premium fittings, a striking freestanding bath, and a luxurious atmosphere designed for comfort.

Externally, residents enjoy well maintained communal grounds, secure entry, and included parking, all within a desirable residential setting. Conveniently positioned near local amenities and transport connections, this attractive apartment combines practicality, comfort, and living well.



Hillary Drive, Isleworth, TW7

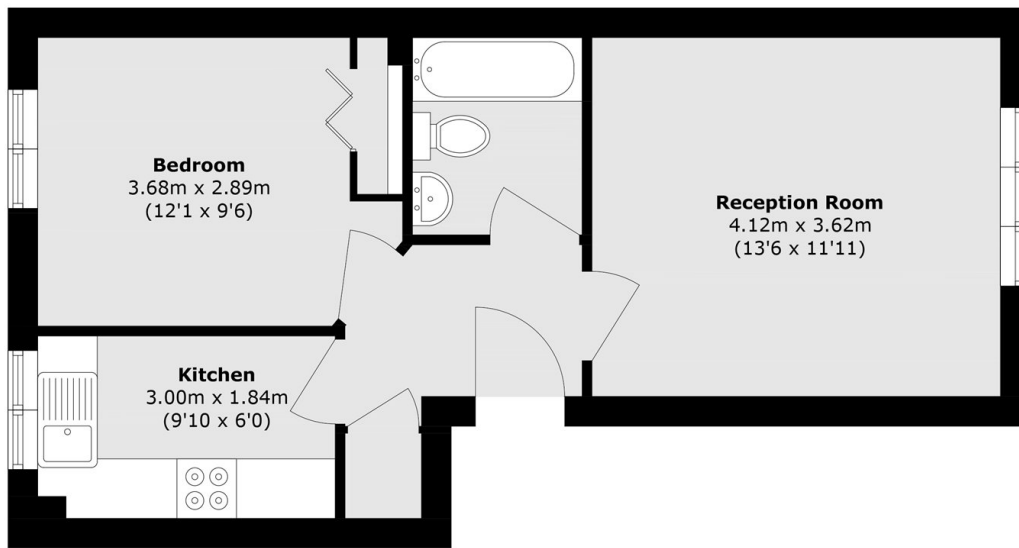

Total area (approx.): 39.9 sq. m (429.4 sq. ft)