

# Towers Wills

Town & Country

📞 01935 577 032 | 01460 298 530 | ✉ info@towerswills.co.uk



## 49, Long Close, Yeovil, Somerset BA21 3SF

Offers Over **£300,000**

Towers Wills are delighted to present to the market this immaculate and superbly presented two-bedroom detached bungalow, situated within a favoured cul-de-sac position on the highly sought-after Abbey Manor development, on the edge of Yeovil. Having been subject to a programme of significant improvement and modernisation by the current owners over recent years, this exceptional home offers stylish and well-appointed accommodation throughout. Improvements include a newly fitted contemporary kitchen and bathroom suite, tasteful redecoration throughout, extensive enhancements to the rear garden and the creation of an enlarged driveway providing off-road parking for two to three vehicles.

### Accommodation:

The accommodation briefly comprises a welcoming entrance hall providing access to the principal rooms. There are two well-proportioned bedrooms, with the generous principal bedroom benefiting from built-in wardrobes. The modern bathroom suite is conveniently positioned off the hallway, whilst a further door leads through to the spacious and comfortable lounge, creating an ideal space for relaxation and entertaining.

The lounge in turn provides access to both the conservatory and the beautifully appointed kitchen, which is fitted with a comprehensive range of modern wall and base units together with integrated appliances, offering both practicality and style.

### Outside:

Externally, the rear garden is a particular feature of the property – a wonderfully private and generously sized outdoor space which has been thoughtfully landscaped to provide an attractive and versatile entertaining area, perfect for enjoying the summer months. There is also pedestrian access to the rear of the single garage.

Further benefits include solar panels, which generate a healthy supplementary income for the current owners, adding to the property's appeal and efficiency.

This outstanding bungalow offers turnkey accommodation within one of Yeovil's most desirable residential locations, and viewing is strongly recommended to fully appreciate the high standard of accommodation on offer.

## Key Features

- Detached Bungalow
- Immaculately Presented Throughout
- Two Bedrooms
- Large Driveway & Garage
- Gardens

## Contact Us

### Towers Wills Estate Agents - Yeovil

114, Hendford Hill  
Yeovil

Somerset  
BA202RF

T: 01935 577032

E: [info@towerswills.co.uk](mailto:info@towerswills.co.uk)

## Energy Efficiency

Score	Energy rating	Current	Potential
92+	A		
81-91	B		88 B
69-80	C		
55-68	D	67 D	
39-54	E		
21-38	F		
1-20	G		



# Floor Plan

Whilst every attempt has been made to ensure the accuracy of the floorplan contained here, measurements of doors, windows, rooms and any other items are approximate and no responsibility is taken for any error, omission or mis-statement. This plan is for illustrative purposes only and should be used as such by any prospective purchaser. The services, systems and appliances shown have not been tested and no guarantee as to their operability or efficiency can be given.  
Made with Metropix ©2026

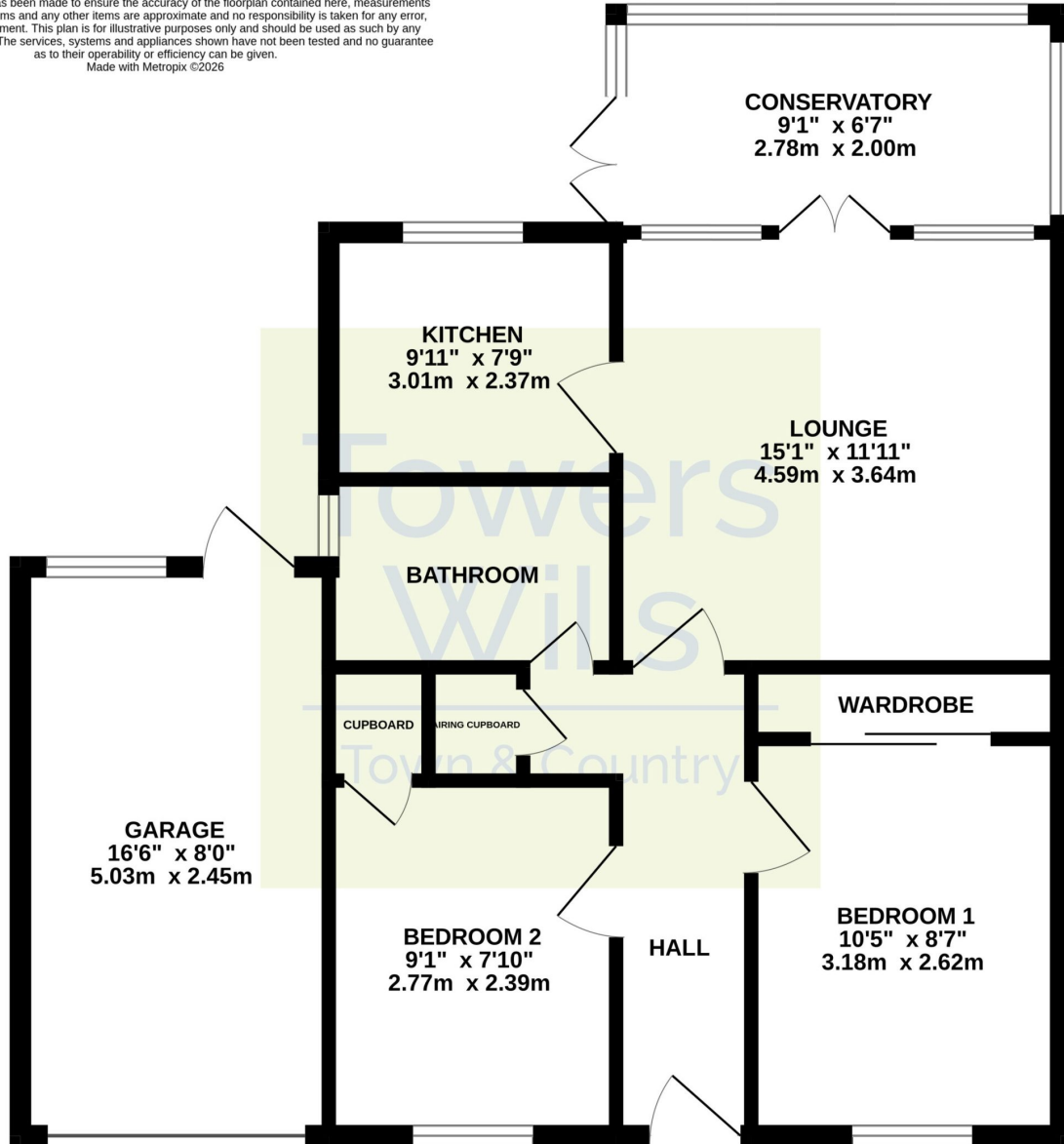

Please Note No tests have been undertaken of any of the services and any intending purchasers should satisfy themselves in this regard. Towers Wills Ltd for themselves and for the vendor of this property whose agents they are, give notice that, (i) these particulars do not constitute any part of an offer or contract, (ii) all statements contained within these particulars are made without responsibility on the part of Towers Wills or the vendor, (iii) whilst made in good faith, none of the statements contained within these particulars are to be relied upon as a statement of representation or fact, (iv) any intending purchaser must satisfy him/herself by inspection or otherwise as to the correctness of each of the statements contained within these particulars, (v) the vendor does not make or give either Towers Wills or any person in their employment any authority to make or give representation or warranty whatsoever in relation to this property.

Photographs / Floor Plans Photographs are reproduced for general information and it must not be inferred that any item is included for sale with this property. Please note floor plans are not to scale and are for identification purposes only. The photographs used in these particulars may have been taken with the use of a wide angle lens. If you have any queries as to the size of the accommodation or plot, please address these with the agent prior to making an appointment to view

**Towers Wills**

The White House, 114 Hendford Hill, Yeovil BA20 2RF

Yeovil 01935 577032 / South Petherton 01460 298530

[info@towerswills.co.uk](mailto:info@towerswills.co.uk) | [www.towerswills.co.uk](http://www.towerswills.co.uk)