

# West Kensington Court

West Kensington, London, W14





# West Kensington Court

## West Kensington, London, W14

Price Guide: £365,000



A well presented fourth floor apartment set within the popular West Kensington Court development, offering bright and well proportioned accommodation in a highly convenient West London location.

The property is presented in really good condition throughout and benefits from a peaceful outlook over the internal courtyard, making it noticeably quieter than many of the road facing apartments within the area. The flat also offers a practical and spacious layout, extending to approximately 519 sq ft, with a generous reception room measuring over 19 ft in length and a well proportioned double bedroom with excellent built in storage.

The apartment further benefits from a separate kitchen, good natural light throughout and a comfortable overall feel, making it ideal for both owner occupiers and investors alike.

West Kensington Court is a sought after purpose built development benefitting from lift access and a 24 hour concierge service, providing both convenience and security for residents. The location is excellent, situated just a short 2 minute walk from West Kensington Station, with easy access to the many cafes, restaurants and local amenities of West Kensington, Barons Court and Kensington High Street.

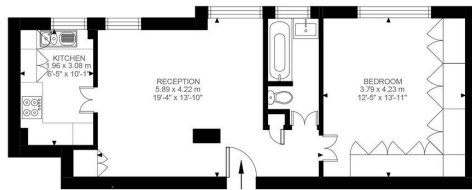

Fourth Floor  
519 ft²

24 hours concierge | Fourth Floor  
Approximately 970 years lease | Lift access | 0.1 Mile from West Kensington Station  
Share of Freehold | 519 Sq. Ft (48.20 Sq. M)

All viewings by appointment through our **West Kensington Office:**

**T:** 020 7385 5020  
**E:** westken@lawsonrutter.com

1 Barons Court Road, London  
W14 9DP

[www.lawsonrutter.com](http://www.lawsonrutter.com)

In accordance with the Property Misdescription Act 1991, we wish to emphasise that the information given in these particulars is intended to help you decide whether you wish to view this property. Whilst every care is taken to ensure the accuracy of these particulars please note that all measurements are approximate and we are, for the accuracy of other information, reliant on what the seller has provided. We strongly recommend that you rely on your own inspections and those of your advisors to establish the details of any aspects which are of particular importance. Please note that we have not undertaken any survey of the property or the appliances within it and the buyer must rely on their own investigations prior to exchange of contracts.



West Kensington Court, W14  
Approximate Gross Internal Area  
48.20 SQ.M / 519 SQ.FT

Illustration for identification purposes only. Not to scale.  
Floor Plan Drawn According To RICS Guidelines.



BRITISH  
PROPERTY  
AWARDS  
2023



BRITISH  
PROPERTY  
AWARDS  
2023

