



RICHMONDS

Osterley Close, Botley, Southampton, SO30 2EX

Offers Over £390,000

A beautifully presented three-bedroom detached family home in immaculate condition ideally located between the villages of Botley and Hedge End.

The property has been extended to feature a fantastic open-plan kitchen/dining room with fitted appliances and plenty of storage which flows seamlessly into the spacious lounge, creating an ideal space for family living and entertaining.

The home benefits from a stylish and modern décor throughout and includes a porch, welcoming entrance hallway and ground floor WC.

Upstairs, there are three well-proportioned bedrooms that share a modern family bathroom. In addition, this lovely property benefits from double glazing and gas central heating.

Externally, there is a detached garage to the side of the property and an attractive rear garden with a raised decked seating area with a pergola over to enjoy alfresco dining.

Other Information

Tenure: Freehold

Approximate Age: Built in the 1970's

Heating: Gas central heating

Windows: Double glazing

Loft: Not inspected

Energy Rating: TBC

Sellers Position: Looking for a local property

Local Information:

Council Tax: D

Local Authority: Eastleigh Borough Council



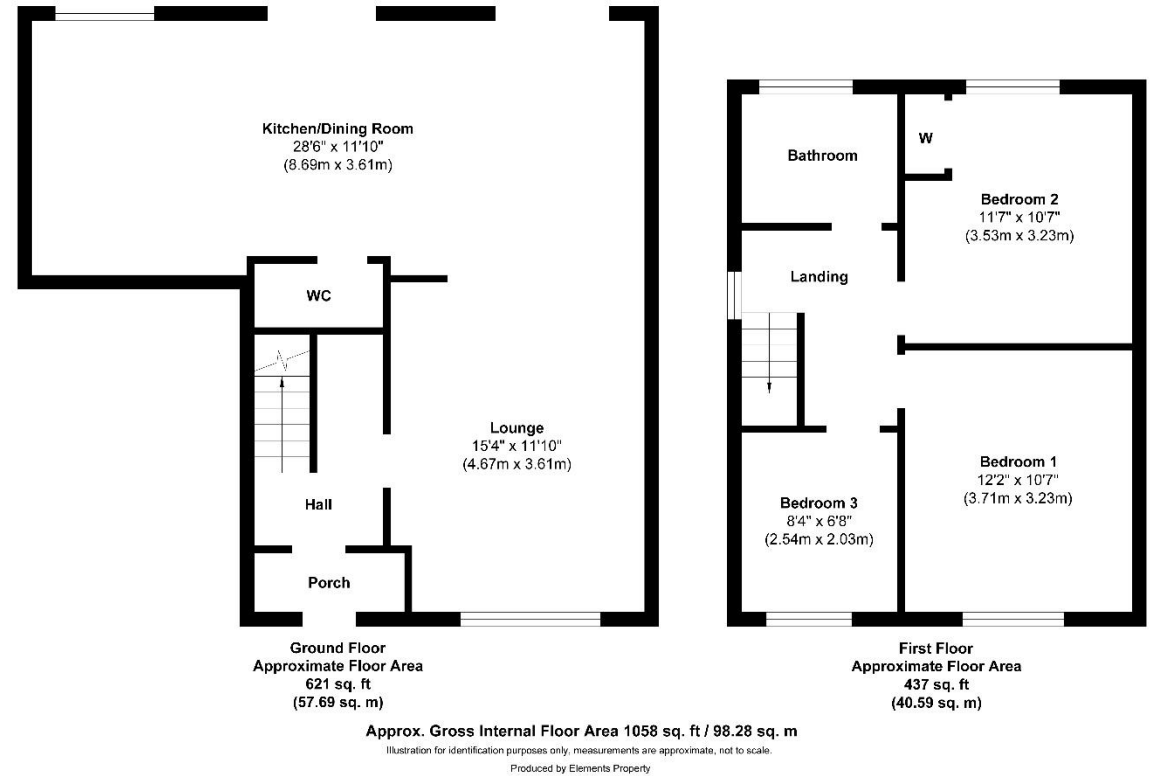

Agents Note: The sellers of the property have provided the above information to us and we are therefore reliant on them providing the correct information. The floor plan and sizes are to be used as a guide only. Please check room sizes prior to ordering carpets or furniture. If you require confirmation on any particular point for specific purposes please contact our office for further information. If you have other questions about this property, please telephone **01489 789933**

R545 Ravensworth 01670 713330

Lankester House, 1 Freegrounds Road, Hedge End, Southampton SO30 0HG • 01489 789933 • admin@richmondsproperty.co.uk

