

**2 Bed
House - Mid Terrace
located in St. Annes Park**



6 Angels Ground
St. Annes Park
Bristol
BS4 4JA



£1,400 Per month

Charming 2-Bedroom House in St Annes – £1,400 pcm

Front Door Lettings is pleased to offer this lovely two-bedroom house in the ever-popular St Annes, just moments from the river and its scenic walking trails. With Netham Park, local shops, and quick links into central Bristol close by, this is an ideal home for a couple or small family.

The ground floor features a modern fitted kitchen with white goods and a dining area to the side, flowing into a large living room with patio doors opening onto the garden. In the corner is a working log burner, a great feature and perfect for cosy winter nights. This room is a lovely bright, sociable space that makes the most of the property's layout.

Upstairs are two good-sized bedrooms, along with a family bathroom featuring a shower over the bath.

In summary:

- Two good-sized bedrooms
- Bathroom with shower over bath
- Modern kitchen with white goods and spacious dining area
- Large living room with patio doors onto the garden
- Sought-after St Annes location close to the river
- Driveway parking



GROUND FLOOR

1ST FLOOR

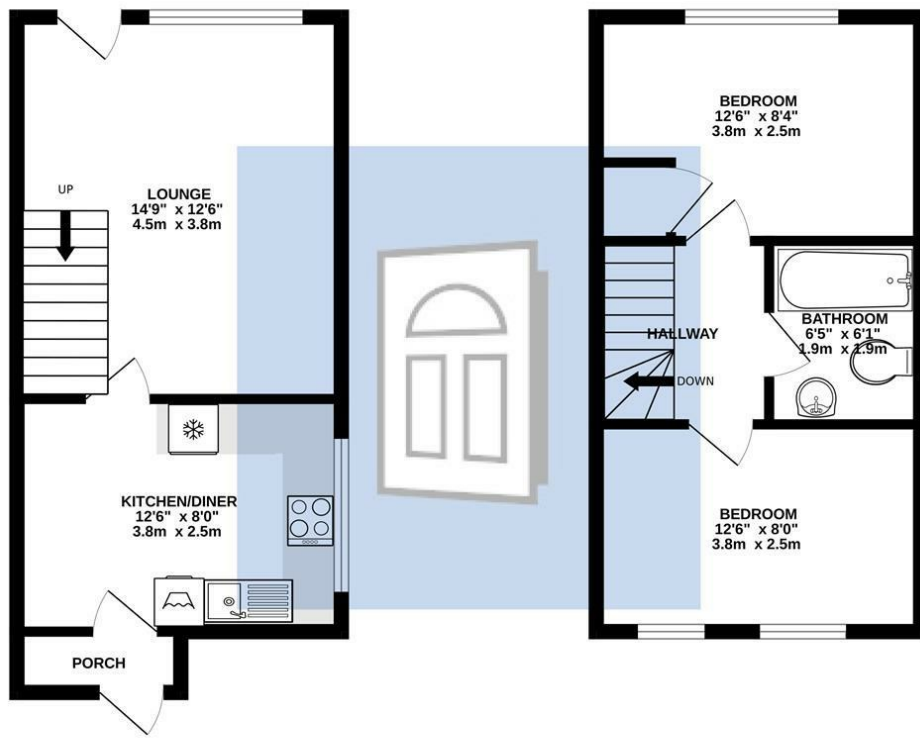

Whilst every attempt has been made to ensure the accuracy of the floorplan contained here, measurements of doors, windows, rooms and any other items are approximate and no responsibility is taken for any error, omission or mis-statement. This plan is for illustrative purposes only and should be used as such by any prospective purchaser. The services, systems and appliances shown have not been tested and no guarantee as to their operability or efficiency can be given.
Made with Metropix ©2026

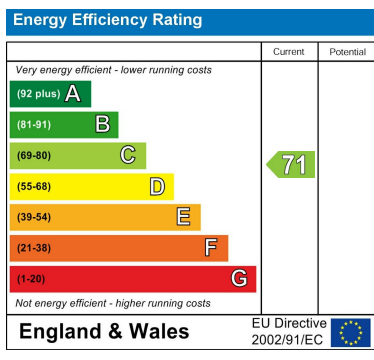

DIRECTIONS

CONTACT

Shore House Westbury Hill
Westbury-on Trym, Bristol
BS9 3AA

E: elliott.sherwood@frontdoorlettings.co.uk

T: 0117 457 8577

frontdoorlettings.co.uk

