



Estate Agents



Auctioneers

Douglas Mews, Southbourne, Bournemouth, Dorset, BH6 5BE

Guide Price £175,000 – Leasehold

One Bedroom Ground Floor Flat | Private Entrance | Reception Room | Kitchen | Bathroom | Bedroom
Allocated Parking Space | Long Lease | No Chain

Spacious One-Bedroom Ground Floor Flat in Prime Southbourne Location – No Chain. A generously sized one-bedroom ground floor flat, ideally located just a few minutes' walk from the vibrant Southbourne Grove, renowned for its wide range of independent shops, bars, and restaurants. The glorious sandy beaches are also less than a mile away, making this a highly desirable location.

Built in 1993 on the historic site of the original Stourfield House, the property benefits from its own private entrance and an allocated parking space situated directly outside the front door. Inside, the accommodation includes a 14ft reception room, a separate fitted kitchen, a 12ft double bedroom, and a three-piece bathroom suite. The flat also features double glazing and electric heating throughout.

The flat has just been redecorated throughout with lovely new carpets and refitted modern kitchen.

An ideal first-time buyer or investment purchase. Offered with no forward chain, early viewing is highly recommended.

Tenure: Leasehold - 996 years remaining on lease

Service Charge: £80.00 per month

Ground Rent: £50.00 per annum

Council Tax Banding: B

EPC Rating: 70 | C





TOTAL FLOOR AREA : 465 sq.ft. (43.2 sq.m.) approx.

Whilst every attempt has been made to ensure the accuracy of the floorplan contained here, measurements of doors, windows, rooms and any other items are approximate and no responsibility is taken for any error, omission or mis-statement. This plan is for illustrative purposes only and should be used as such by any prospective purchaser. The services, systems and appliances shown have not been tested and no guarantee as to their operability or efficiency can be given.

Made with Metropix ©2025

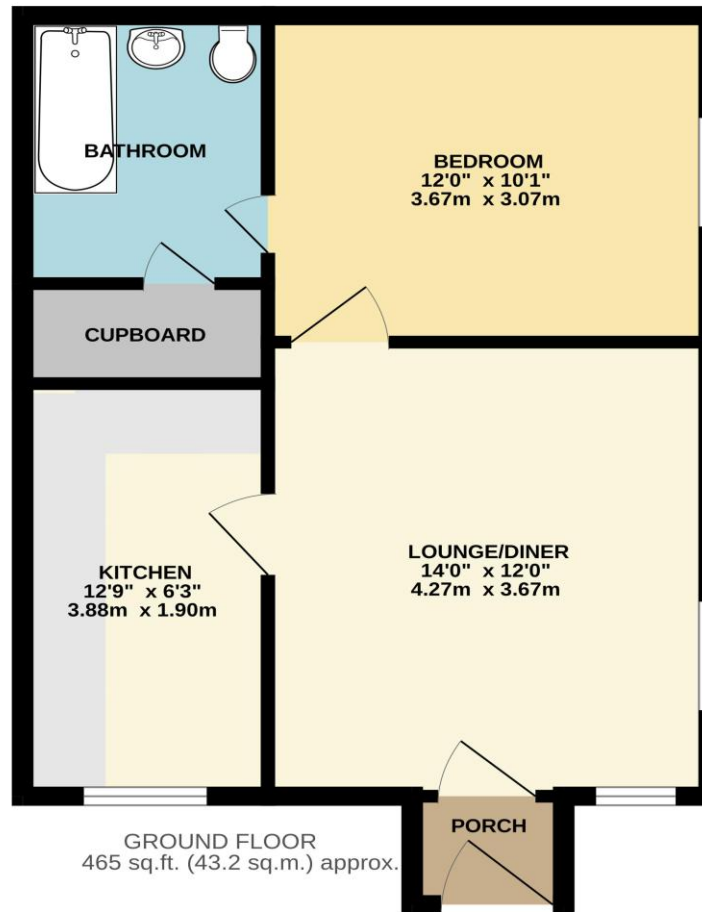

Disclaimer These particulars, whilst believed to be accurate are set out as a general outline only for guidance and do not constitute any part of an offer or contract. Intending purchasers should not rely on them as statements of representation of fact, but must satisfy themselves by inspection or otherwise as to their accuracy. We have not carried out a detailed survey nor tested the services, appliances and specific fittings. Room sizes should not be relied upon for carpets and furnishings. The measurements given are approximate. No person in this firm's employment has the authority to make or give any representation or warranty in respect of the property.

Richard Godsell – Estate Agents – Auctioneers

3 Southbourne Grove • Southbourne • Bournemouth • BH6 3RE

Tel: 01202 424214 | Email: southbourne@richardgodsell.com

Offices at

Southbourne • Christchurch • London

www.richardgodsell.com

