



## WANDSWORTH ROAD, SW8

£325,000

Victorian conversion  
First floor apartment  
Clapham old town  
Good condition  
106 year lease  
Chain free

@marshandparsons  
marshandparsons.co.uk

MARSH &  
PARSONS



# ABOUT THE PROPERTY

A bright and spacious one bedroom Victorian conversion flat ideally located for the amenities of Clapham Old Town and wide open spaces of Clapham Common. Long lease and chain free.

The flat is situated on the first floor of a Victorian building on the corner of both Wandsworth Road and North Street, one of the original surviving village streets in Clapham Old Town. Transport links include Clapham Common Underground (Northern Line) and Wandsworth Road station, offering direct services to both Clapham Junction and Canary Wharf via Canada Water. These along with excellent local bus routes provide quick and easy access into The City and the West End.



# STEP INSIDE WANDSWORTH ROAD

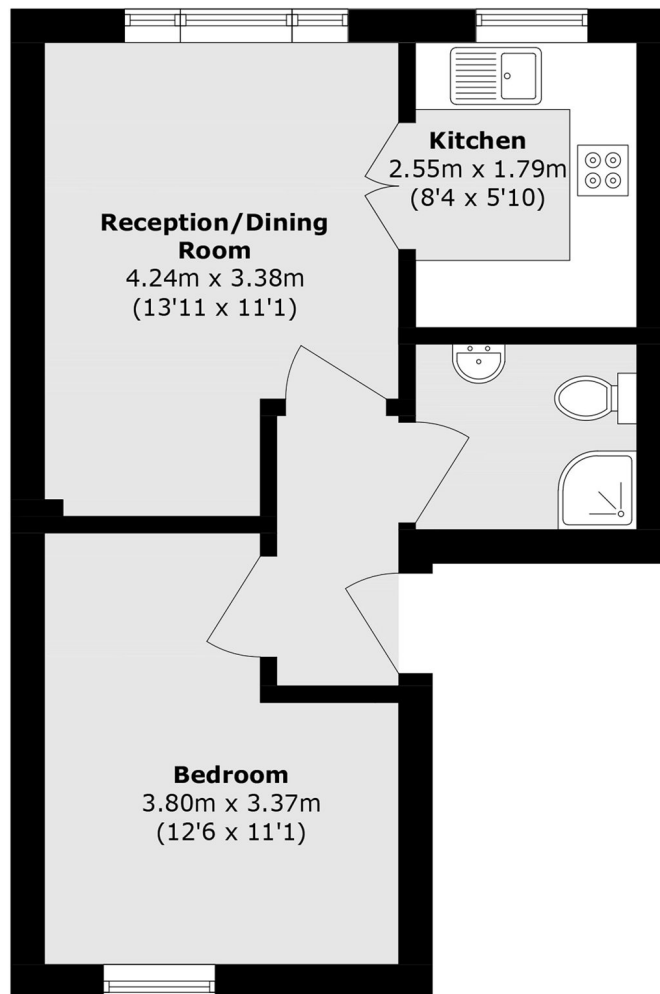

Total area (approx.): 35.4 sq. m (381.0 sq. ft)

**Clapham**  
020 7501 3666

Energy Rating: C We aim to make our particulars both accurate and reliable. However, they are not guaranteed; nor do they form part of an offer or contract. If you require clarification on any points then please contact us, especially if you're traveling some distance to view. Please note that appliances and heating systems have not been tested and therefore no warranties can be given as to their good working order

**MARSH &  
PARSONS**