

Park Bank, Atherton, M46 9QQ
£340,000

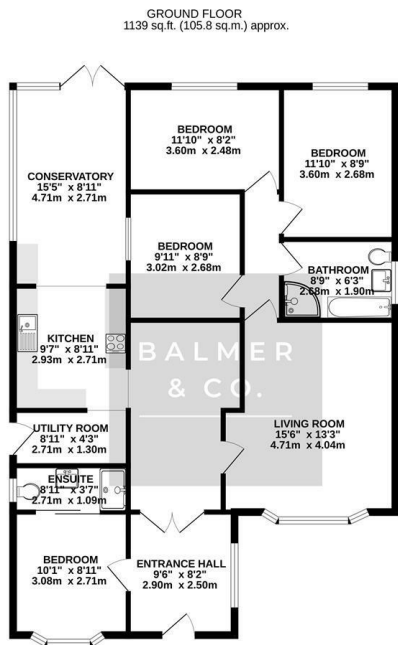

BALMER & CO in ATHERTON are delighted to offer for sale this four bedroom detached true bungalow located on Park Bank, a quiet cul-de-sac in one of Atherton's most sought after areas. Occupying a fantastic corner plot it offers spacious and versatile accommodation and is offered for sale with no onward chain. Comprising in brief; entrance hallway, spacious living room, fitted kitchen/dining room with separate utility room and conservatory, four bedrooms, three doubles and one single with one double benefitting from an en-suite shower room. A four piece bathroom suite completes the internal accommodation. Externally there are gardens to the front, side and rear with ample off road parking. Early viewings highly recommended, all enquiries welcome.

Floor Plan



TOTAL FLOOR AREA: 1139 sq.ft. (105.8 sq.m.) approx.
While every attempt has been made to ensure the accuracy of the floorplan contained here, measurements of doors, windows, rooms and any other levels are approximate and no responsibility is taken for any minor omissions or misstatements. This plan is for illustrative purposes only and should be used as such by any prospective purchaser. The services depicted on this plan have been reviewed and the purchaser is to be responsible for any errors or omissions.
Made with Mapbox C2025

Area Map

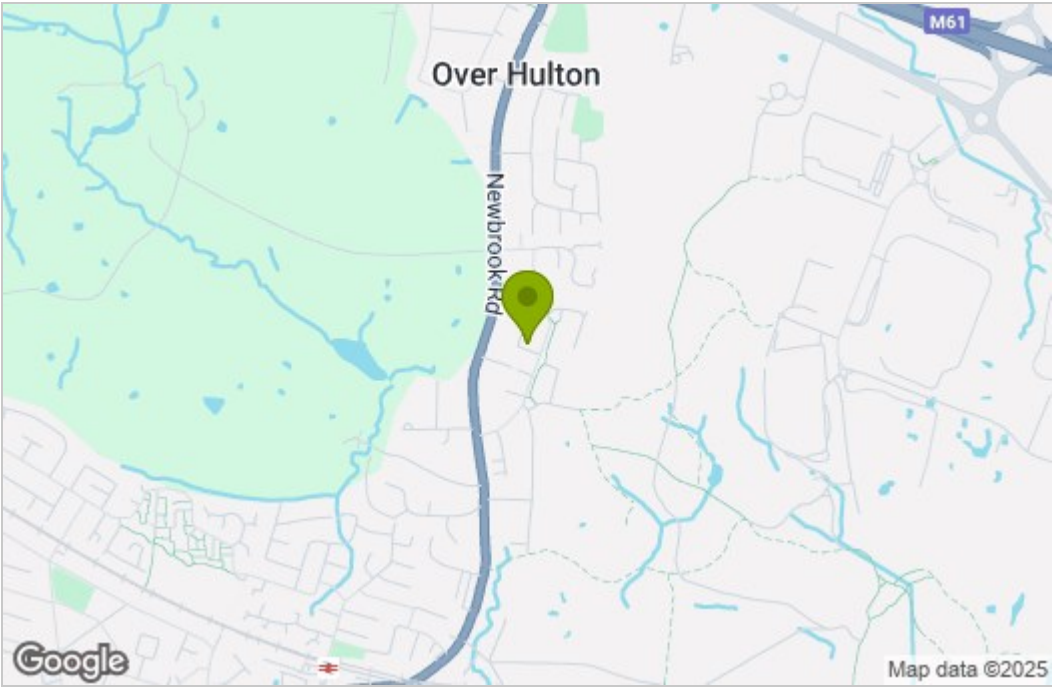

Energy Efficiency Graph

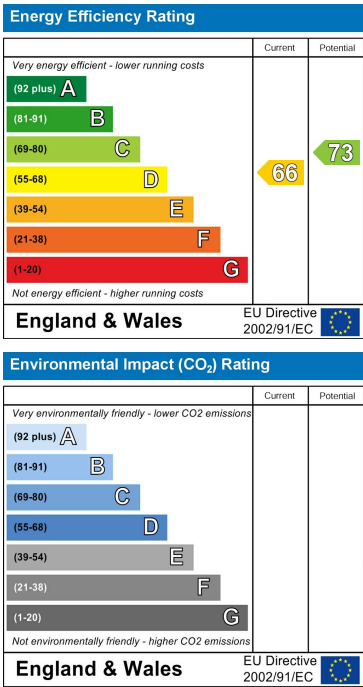

These particulars, whilst believed to be accurate are set out as a general outline only for guidance and do not constitute any part of an offer or contract. Intending purchasers should not rely on them as statements of representation of fact, but must satisfy themselves by inspection or otherwise as to their accuracy. No person in this firm's employment has the authority to make or give any representation or warranty in respect of the property.