



Walton Court Gardens, KT12

£750,000

Show Home Available To View - The Hexham is a unique collection of just six stunning four bedroom townhouses, spread over three floors offering great versatility for an ideal family home. Each house comprises a spacious ground floor with an open-plan kitchen/dinner, with bi-fold doors leading to a private rear garden, perfect for al fresco dining, separate reception/bedroom, providing a cosy retreat and a downstairs W.C. On the first floor is a generously sized living room and principle double bedroom, with an en-suite shower room. On the second floor are two additional double bedrooms, a home office and a three piece family bathroom suite. Further benefits include allocated off-street parking for two cars and residents can also enjoy exclusive access to a fully equipped gym, located on-site.

Respecting its treasured past, the former historic Grade II listed Birds Eye headquarters has made way for the creation of a new landmark for the area. These stunning apartments and town houses are situated just a three-minute walk from Walton-on-Thames station, providing residents with excellent access to London Waterloo in just 26 minutes.

Features

- New Build
- ICW 10 Year Build Warranty
- On Site Gym
- Freehold
- 2 Parking Spaces
- Close To Station

Walton Court Gardens, Walton On Thames, KT12



GROUND FLOOR

KITCHEN / DINING AREA

5.02m x 4.36m 16'5" x 14'3"

BEDROOM 4 / LOUNGE

3.62m x 2.67m 11'9" x 8'7"



FIRST FLOOR

LIVING ROOM

5.02m x 4.13m 16'5" x 13'6"

BEDROOM 1

3.92m x 2.79m 12'8" x 9'2"

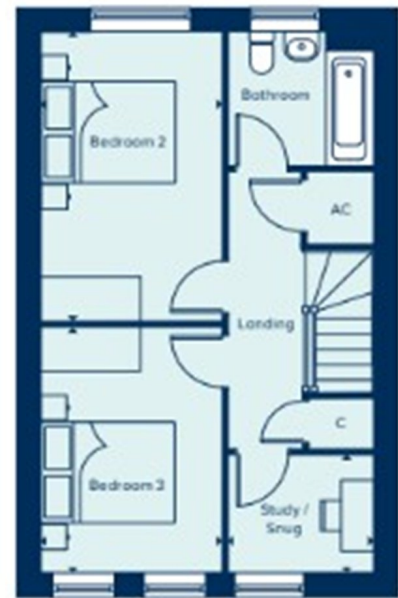

SECOND FLOOR

BEDROOM 2

4.35m x 2.75m 14'3" x 9'0"

BEDROOM 3

3.70m x 2.74m 12'1" x 9'0"

STUDY / SNUG

2.21m x 1.80m 7'3" x 5'9"