

Towers Wills

Town & Country

📞 01935 577 032 | 01460 298 530 | ✉ info@towerswills.co.uk



57, Falcon Road, Yeovil, Somerset BA22 8BR

£260,000

Towers Wills are delighted to present to the market this beautifully presented three-bedroom end-of-terrace home. Situated within the ever-popular Agusta Park development, this superb property has been lovingly maintained by the current owners and offers comfortable, modern living throughout.

Accommodation:

The ground floor features a welcoming and well-proportioned lounge, providing an ideal space to relax and unwind, which flows seamlessly into a stylish and well-equipped modern kitchen. The kitchen benefits from patio doors opening directly onto the rear garden, creating a wonderful connection between indoor and outdoor living and making it perfect for entertaining.

To the first floor, the property offers three bedrooms, with the main bedroom enjoying the added luxury of its own en-suite shower room. The remaining bedrooms are served by a contemporary family bathroom, making this an ideal home for families, professionals, or first-time buyers alike.

Outside:

Externally, the rear garden has been thoughtfully landscaped, featuring a raised decked seating area ideal for outdoor dining and a lawned section to the lower part of the garden, offering both practicality and charm.

Further benefits include driveway parking for two cars located nearby, along with the advantages of being positioned in a sought-after residential area with good access to local amenities and transport links.

An early viewing is highly recommended to fully appreciate the quality and location of this delightful home.

Key Features

- Popular Agusta Park Development
- End Terrace
- Three Bedrooms
- Master En suite
- Well Presented
- Driveway Parking for Two Cars
- Rear Garden

Contact Us

Towers Wills Estate Agents - Yeovil
114, Hendford Hill
Yeovil
Somerset
BA202RF
T: 01935 577032
E: info@towerswills.co.uk

Energy Efficiency

Score	Energy rating	Current	Potential
92+	A		96 A
81-91	B	83 B	
69-80	C		
55-68	D		
39-54	E		
21-38	F		
1-20	G		



Floor Plan

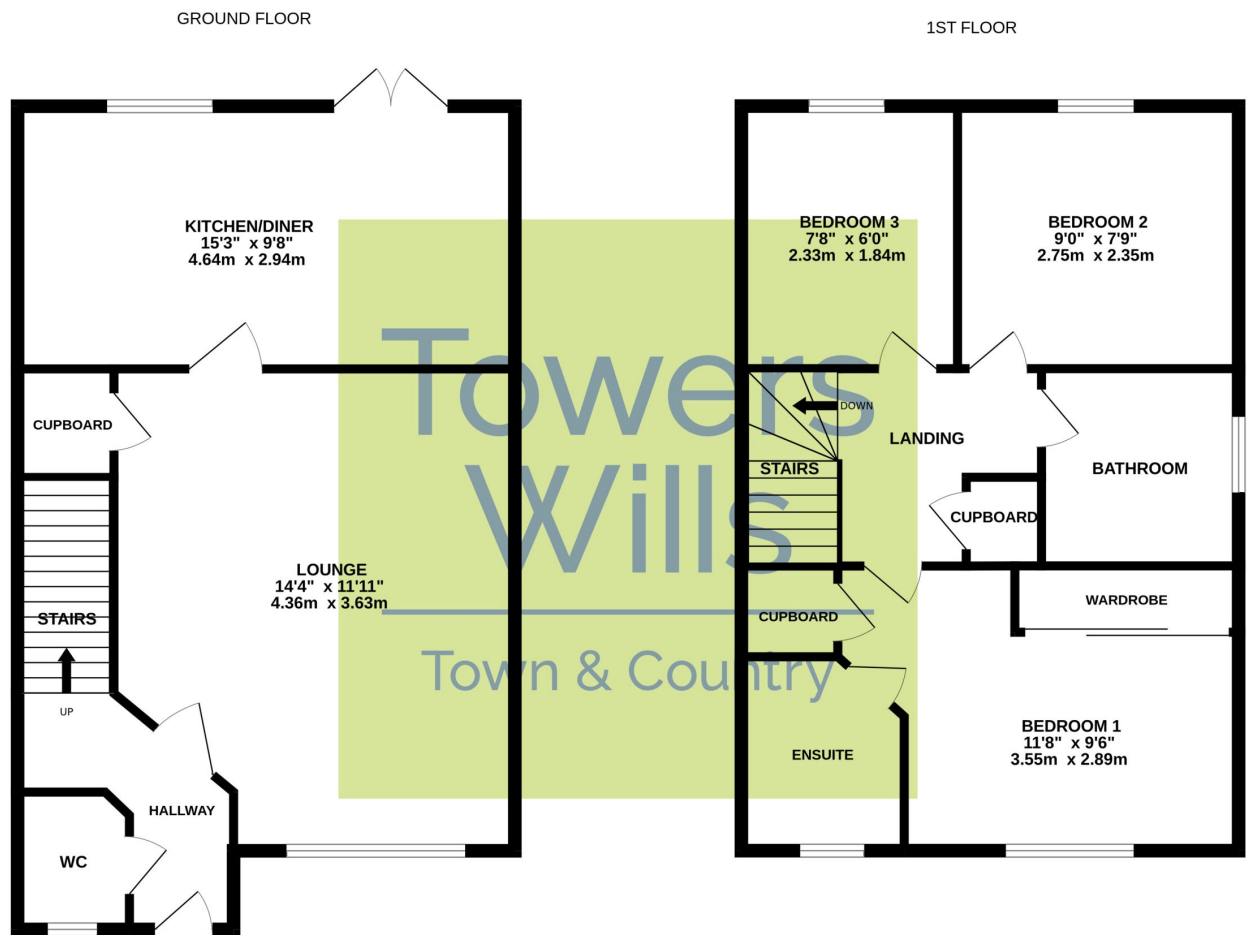

Whilst every attempt has been made to ensure the accuracy of the floorplan contained here, measurements of doors, windows, rooms and any other items are approximate and no responsibility is taken for any error, omission or mis-statement. This plan is for illustrative purposes only and should be used as such by any prospective purchaser. The services, systems and appliances shown have not been tested and no guarantee as to their operability or efficiency can be given.
Made with Metropix ©2023

Please Note No tests have been undertaken of any of the services and any intending purchasers should satisfy themselves in this regard. Towers Wills Ltd for themselves and for the vendor of this property whose agents they are, give notice that, (i) these particulars do not constitute any part of an offer or contract, (ii) all statements contained within these particulars are made without responsibility on the part of Towers Wills or the vendor, (iii) whilst made in good faith, none of the statements contained within these particulars are to be relied upon as a statement of representation or fact, (iv) any intending purchaser must satisfy him/herself by inspection or otherwise as to the correctness of each of the statements contained within these particulars, (v) the vendor does not make or give either Towers Wills or any person in their employment any authority to make or give representation or warranty whatsoever in relation to this property.

Photographs / Floor Plans Photographs are reproduced for general information and it must not be inferred that any item is included for sale with this property. Please note floor plans are not to scale and are for identification purposes only. The photographs used in these particulars may have been taken with the use of a wide angle lens. If you have any queries as to the size of the accommodation or plot, please address these with the agent prior to making an appointment to view

Towers Wills

The White House, 114 Hendford Hill, Yeovil BA20 2RF

Yeovil 01935 577032 / South Petherton 01460 298530

info@towerswills.co.uk | www.towerswills.co.uk