



Hereford Road, W2

£535,000



- Large Windows
- High Ceilings
- Westerly Aspect
- Just off Westbourne Grove
- Close to Hyde Park
- Superb Transport Links

HEREFORD ROAD, W2

Approx. gross internal area
490 Sq Ft. / 45.6 Sq M.

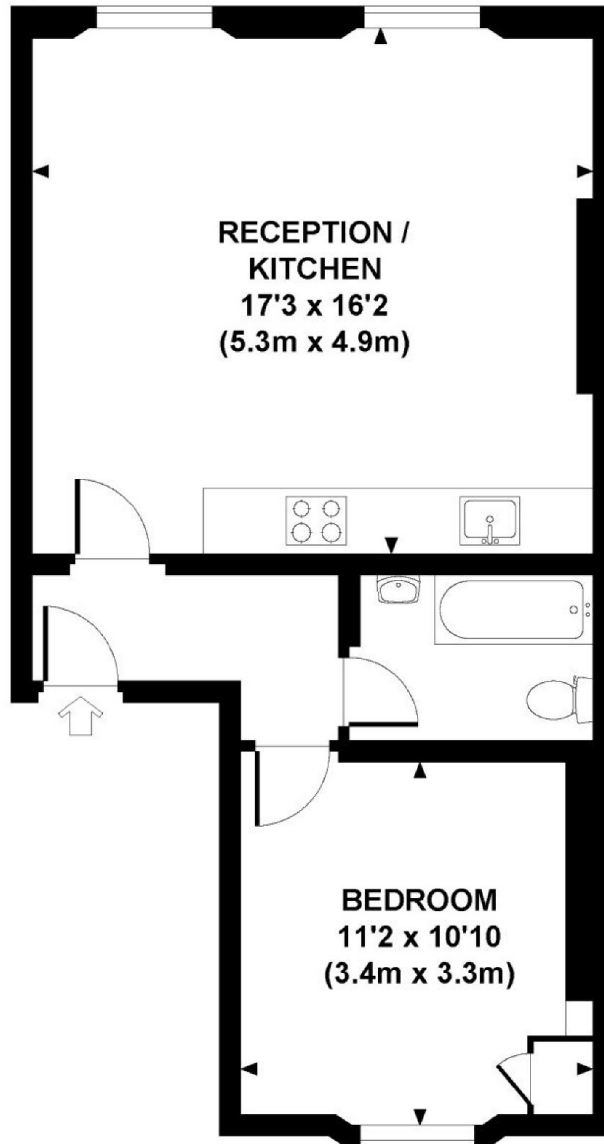

SECOND FLOOR



All measurements are approximate and for illustration purposes only as defined by the RICS Code of Measuring Practice © 2013
Dowling Jones Design www.dowlingjones.com 020 7610 9933

Marsh & Parsons Notting Hill

2-6 Kensington Park Road,
London, W11 3BU
020 7313 2890

We aim to make our particulars both accurate and reliable. However, they are not guaranteed; nor do they form part of an offer or contract. If you require clarification on any points then please contact us, especially if you're traveling some distance to view. Please note that appliances and heating systems have not been tested and therefore no warranties can be given as to their good working order.