



## Rathbone Market, E16

### £385,000

Welcome to this charming two-bedroom home, situated within the sought-after Rathbone Market development. The property features a private balcony, two bathrooms, and is offered on a chain-free basis.

Rathbone Market is just 0.4 miles from Canning Town Station, providing excellent transport links across the City and beyond.

### Features

- Sought After Development
- Close To Station
- Private Balcony
- Two Bedrooms
- Secure Entry System
- Chain Free

# Rathbone Market, London, E16

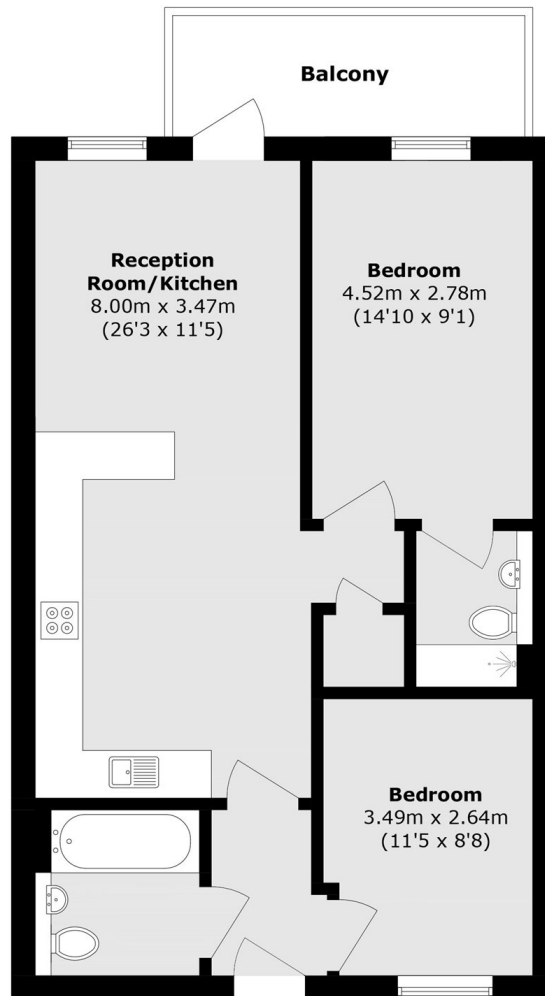

Total area (approx.): 64.4 sq. m (693.2 sq. ft)

Balcony area (approx.): 6.7 sq. m (72.1 sq. ft)