



Rugby Road, Hampshire, PO5 1SH Asking Price £370,000

This beautiful and substantial END OF TERRACE property, with GARAGE and option for further off street parking, in the heart of Portsmouth, is not to be missed!

Perfectly situated, this property is close to the town centre, shops, bars, cafes, bus routes, the train station and close to the seafront too.

The property has ample space and can accommodate five double bedrooms or four double bedrooms and a lounge, as well as the kitchen with living space or dining area. There's an additional downstairs WC, a hard standing / courtyard garden AND A GARAGE!

The property is very flexible and can easily accommodate reception rooms / living spaces or bedrooms and can be easily adapted to suit your every need.

The property is CHAIN FREE, VACANT and ready for new owners!

The property is presented with photos when the property was occupied but please be advised that the property is now vacant and the living spaces are now empty and furniture free.

Rugby Road, Hampshire, PO5 1SH

Kitchen 9'1" x 9'8" (2.78 x 2.96)

Dining room 11'11" x 12'7" (3.65 x 3.86)

WC 2'4" x 4'8" (0.72 x 1.43)

Bedroom 4 9'6" x 10'5" (2.90 x 3.20)

Bathroom 5'6" x 6'10" (1.69 x 2.09)

Bedroom 1 10'6" x 12'7" (3.21 x 3.86)

Bedroom 2 9'1" x 9'11" (2.79 x 3.04)

Bedroom 3 10'2" x 6'8" (3.10 x 2.05)

Lounge / bedroom 5 10'6" x 12'7" (3.21 x 3.85)

Ground Floor

Approx. 63.7 sq. metres (685.5 sq. feet)



First Floor

Approx. 52.3 sq. metres (562.8 sq. feet)

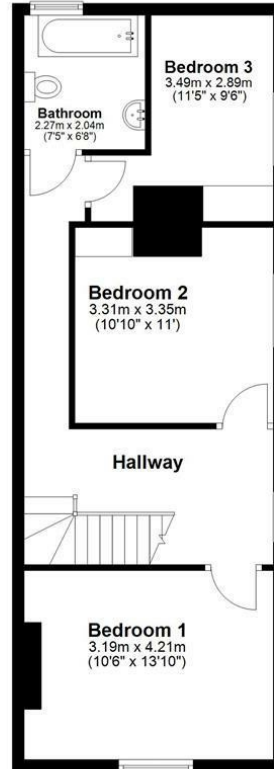

Total area: approx. 116.0 sq. metres (1248.4 sq. feet)

