



Flat 22

St. Peters Street | | Maidstone | ME16 0GR

£1,250 Per month



Flat 22

St. Peters Street |

Maidstone | ME16 0GR

£1,250 Per month

Machin Lane are delighted to offer this fantastic 3rd floor Apartment with TWO BEDROOMS, TWO BATHROOMS AND TWO PARKING SPACES! located in the heart of Maidstone. Walking distance to the High Street, supermarkets and Railway Station. Offering entrance hallway, spacious lounge, kitchen with oven and hob, two bedrooms - master with en-suite. Main bathroom includes bath and overhead shower. Allocated parking for two cars. Available from 25th July.

A refundable holding deposit is required to reserve a property at one week's rent and this is calculated by multiplying the monthly rent by twelve and divide by fifty two. This is to reserve a property. This will be withheld if any relevant person (including any guarantor(s)) withdraw from the tenancy, fail a Right-to-Rent check, provide materially significant false or misleading information, or fail to sign their tenancy agreement (and / or Deed of Guarantee) within 15 calendar days (or other Deadline for Agreement as mutually agreed in writing). With agreement, the holding deposit can be credited against the first months rent due upon successful referencing and agreed move in.

- TWO BEDROOM APARTMENT
- WALKING DISTANCE TO TOWN CENTRE & AMENITIES
- EN SUITE TO MASTER BEDROOM
- TWO PARKING SPACES
- 1 WEEK HOLDING DEPOSIT £288.46 (RENTX12/52)
- 5 WEEK DEPOSIT £1442.30 (RENTX12/52X5)
- COUNCIL TAX BAND D
- AVAILABLE LATE JULY

CLIENT MONEY PROTECTION

MACHIN LANE LTD - CLIENT MONEY PROTECTION NUMBER C0141304

PROPERTY REDRESS SCHEME

REDRESS SCHEME - THE PROPERTY OMBUDSMAN- MEMBERSHIP NUMBER T09116

ENTRANCE HALL

LIVING ROOM

KITCHEN





BATHROOM

BEDROOM ONE

EN-SUITE SHOWER ROOM

BEDROOM TWO





ME16 0GR - Flat 22, Scotney Gardens, St. Peters Street, Mai

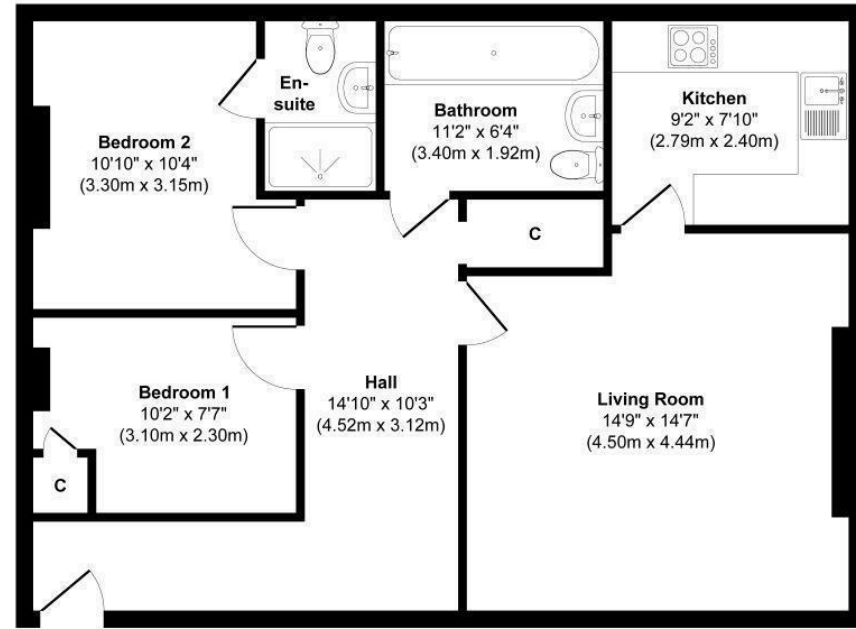

Floor Plan

Approx. Gross Internal Floor Area 717 sq. ft / 66.69 sq. m

Whilst every attempt has been made to ensure the accuracy of the floor plan contained here, measurements of doors, windows, rooms and any other items are approximate and no responsibility is taken for any error, omission, or mis-statement. The measurements should not be relied upon for valuation, transaction and/or funding purposes. This plan is for illustrative purposes only and should be used as such by any prospective purchaser or tenant.

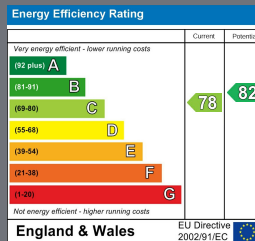

2B Crow Lane
 Rochester
 Kent
 ME1 1RF
 01634 829080

admin@machin-lane.co.uk
<https://www.machin-lane.co.uk/>