

Holden Road, Leigh, WN7 2HU
Offers Over £199,995

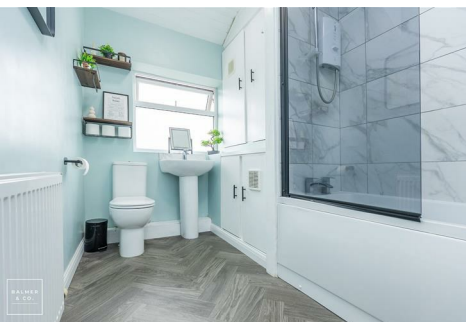

BALMER & CO in LEIGH are delighted to offer FOR SALE this fantastic three bedroom mid-terrace house on the ever popular Holden Road. Very nicely presented throughout and offering excellent living space, this property makes an excellent family home. Comprising in brief of entrance hallway, large bay fronted living room, modern fitted kitchen, separate dining room with French doors leading to teh rear garden, with a utility cupboard completing the ground floor. To the first floor is a large master bedroom with fitted wardrobes, second double bedroom, third single bedroom, with a modern three piece family bathroom completing the accommodation on offer. Externally the property is garden fronted, whilst to the rear there is low maintenance, South facing garden. The property is also ideally situation within walking distance of the Leigh-Manchester guided busway, Bedford High School and other local amenities. Early viewings highly recommended, all enquiries welcome.

Floor Plan

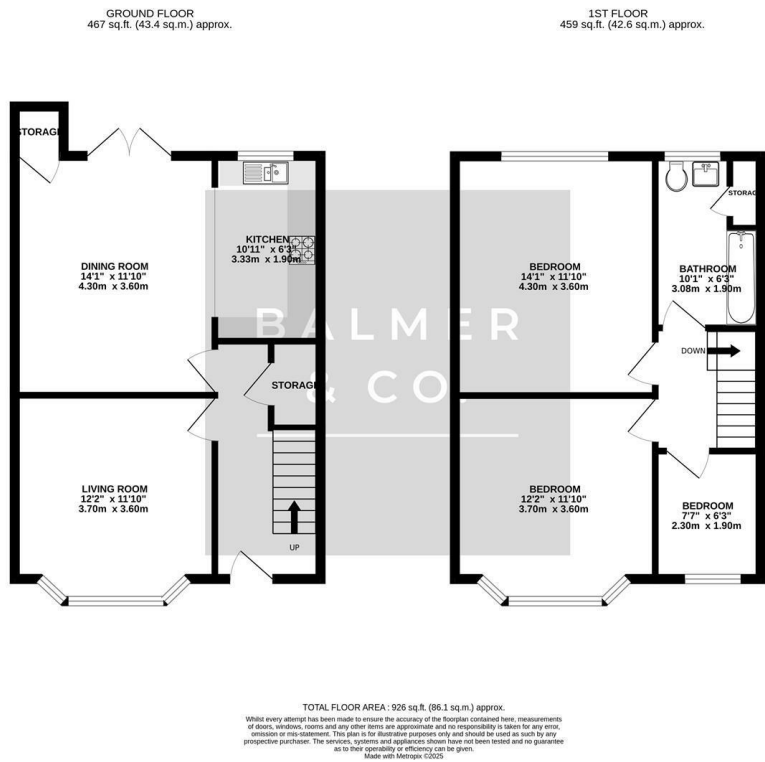

Area Map

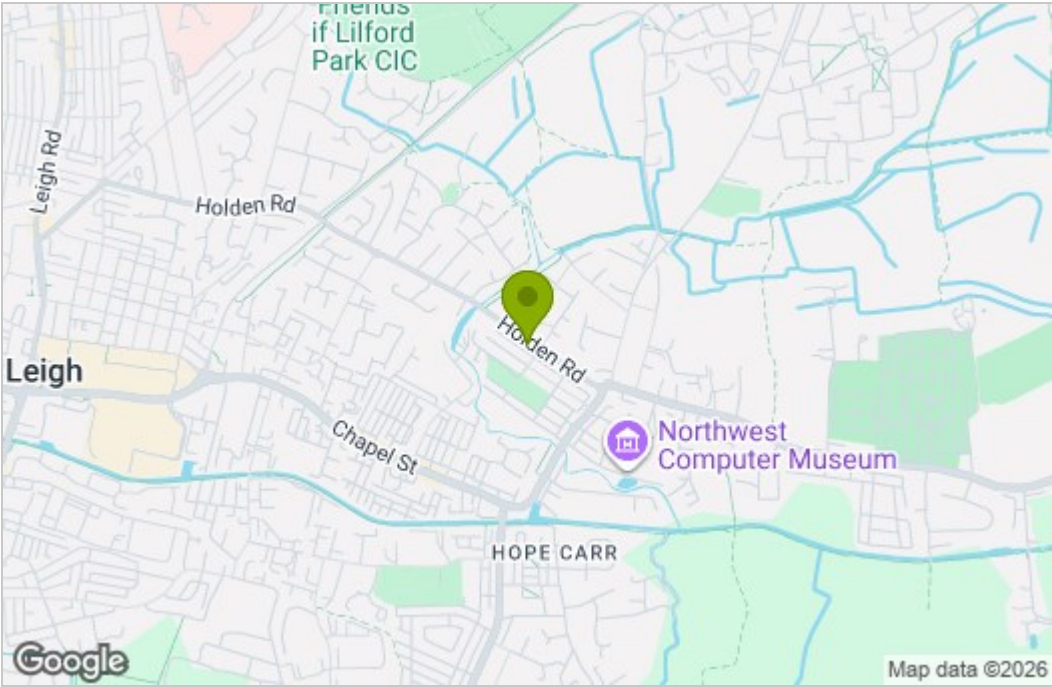

Energy Efficiency Graph

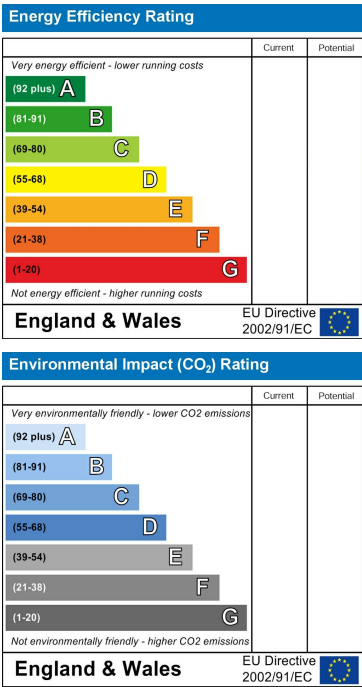

These particulars, whilst believed to be accurate are set out as a general outline only for guidance and do not constitute any part of an offer or contract. Intending purchasers should not rely on them as statements of representation of fact, but must satisfy themselves by inspection or otherwise as to their accuracy. No person in this firms employment has the authority to make or give any representation or warranty in respect of the property.