

Westfield Road, London, W13
Approximate Floor Area = 80.3 sq m / 864 sq ft

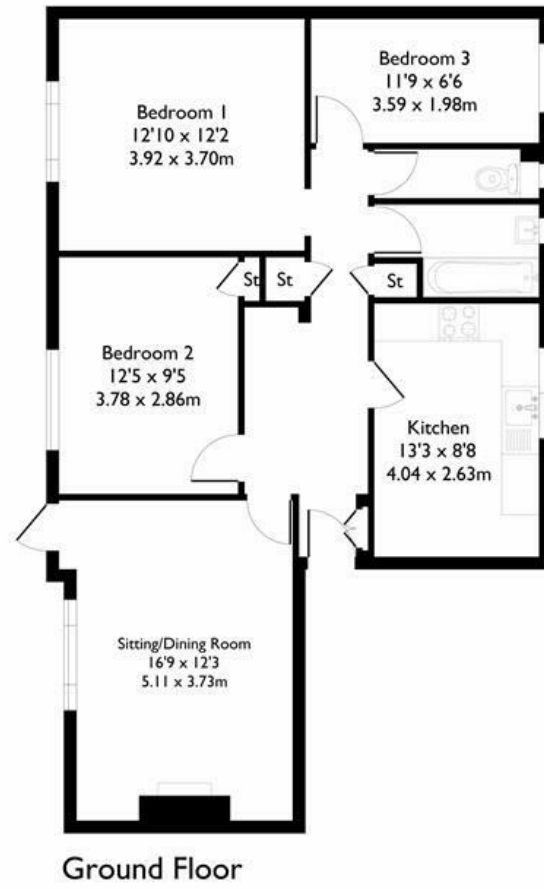

MAISONETTE

FEATURES

Westfield Road W13
£1,750 PCM

Floor plan produced in accordance with RICS Property Measurement 2nd Edition. Although Pink Plan Ltd ensures the highest level of accuracy, measurements of doors, windows and rooms are approximate and no responsibility is taken for error, omission or misstatement. These plans are for representation purposes only and no guarantee is given on the total square footage of the property within this plan. The figure icon is for initial guidance only and should not be relied on as a basis of valuation.



MAISONETTE

Westfield Road W13

£1,750 PCM

Available for a maximum of 3 months.

This substantial three bedroom maisonette is ideally located just off of Northfield Avenue, within walking distance of local shops, restaurants and tube station whilst also affording easy access to Ealing Broadway town centre.

The property itself is an excellent size with large reception room with direct access on to a private garden, separate fitted eat in kitchen, family sized bathroom with shower and separate WC. Other benefits include excellent built in storage.

