



## Hermitage Street, W2

£675,000

A two bedroom apartment in a portered modern block with balcony. The property has an open plan reception with room to dine, modern kitchen and access to the balcony, whilst the principal bedroom has en suite and built in wardrobes.

Moments from Paddington Station and the Heathrow Express, the property is within easy reach of Sheldon Square, Little Venice and the Grand Union Canal.

### Features

Two Bedrooms  
Balcony  
New Build  
Modern  
Porter

# Hermitage Street, London, W2

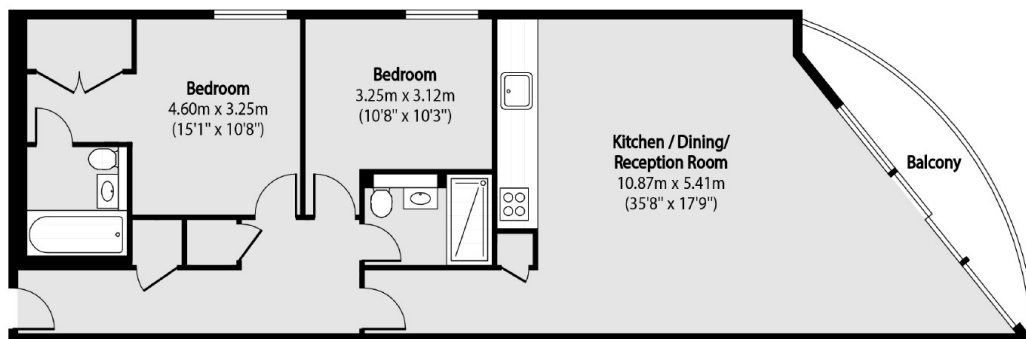

Total area (approx): 76.18 sq m (820 sq. ft)

Balcony total area (approx): 5.20 sq m (56 sq. ft)

## Dexters

Hyde Park and Bayswater  
4-5 Spring Street  
London  
W2 3RA  
Sales  
020 7298 1550

Energy Rating: C. We aim to make our particulars both accurate and reliable. However they are not guaranteed; nor do they form part of an offer or contract. If you require clarification on any points then please contact us, especially if you're traveling some distance to view. Please note that appliances and heating systems have not been tested and therefore no warranties can be given as to their good working order.

 **RICS** | Regulated  
Estate Agent  
and Letting Agent

[dexters.co.uk](https://www.dexters.co.uk)