



3 Beechwood Close, Watlington, King's Lynn PE33 0HP

£309,995

Bedrooms: 3 | Bathrooms: 1 | Receptions: 1

Welcome to 3 Beechwood Close, a home that doesn't just tick boxes, it quietly raises the standard.

Tucked into the ever-popular village of Watlington, this detached bungalow has been completely reimaged into a refined three-bedroom retreat where clean design meets everyday ease. Step inside and you'll notice it immediately: the flow feels natural, the light moves effortlessly from room to room, and every finish has been chosen with intention rather than routine.

The heart of the home is a seamless living space that invites both slow mornings and lively evenings. The lounge opens comfortably into the kitchen, creating a sociable layout that feels connected without losing its sense of calm. The kitchen itself balances style and function with shaker cabinetry, marble-effect worktops and a breakfast bar that's just as suited to a quick coffee as it is to lingering conversations.

There's a quiet confidence to the layout. Three well-proportioned bedrooms offer flexibility, whether you need space to rest, work, or simply breathe. Bedroom two, with its patio doors opening directly onto the garden, adds a subtle indoor-outdoor rhythm that makes the home feel bigger than its footprint.

The shower room continues the theme: clean lines, quality fittings, and a finish that feels more boutique than purely practical.

Outside, the property keeps things simple in the best possible way. A private rear garden blends lawn and patio, giving you space to unwind, host, or do very little at all. To the front, a generous driveway, garage, and dual access points make day-to-day living effortless.

And then there's the setting. Watlington offers that rare balance, a village feel with genuine connectivity. Whether it's a straightforward commute to King's Lynn or a longer journey into London, you're well placed without feeling tied down.

This isn't just a renovated bungalow. It's a home designed for how life actually unfolds, easy, adaptable, and quietly impressive from the moment you walk in.

Tenure: Freehold

Property Type: Detached Bungalow

- Detached Bungalow
- Three Bedrooms
- Fully Modernised - Stunning Throughout
- Contemporary Kitchen
- Stylish Shower Room
- Private Rear Garden
- Garage and Off-road Parking
- Solar Panels
- Bright and Airy Living Space
- Close to heart of Village and Train Station

Disclaimer

1. To meet money-laundering regulations, all buyers will need to complete an ID check. We'll ask you to provide the necessary documents, and there's a small fee of £20.50 per client for this service.
2. We do our best to make sure our property details are fair, accurate, and up to date, but they're meant as a general guide only. If there's anything particularly important to you, please get in touch – we'll be happy to look into it further.
3. All measurements are provided as a guide and may not be exact.
4. We haven't tested any of the property's services, equipment, or appliances. We recommend that buyers arrange their own survey or service checks before making a final offer.
5. These details are provided in good faith, but they don't form part of any offer or contract. Buyers should verify any points that are important to them before proceeding.



GROUND FLOOR
907 sq.ft. (84.2 sq.m.) approx.

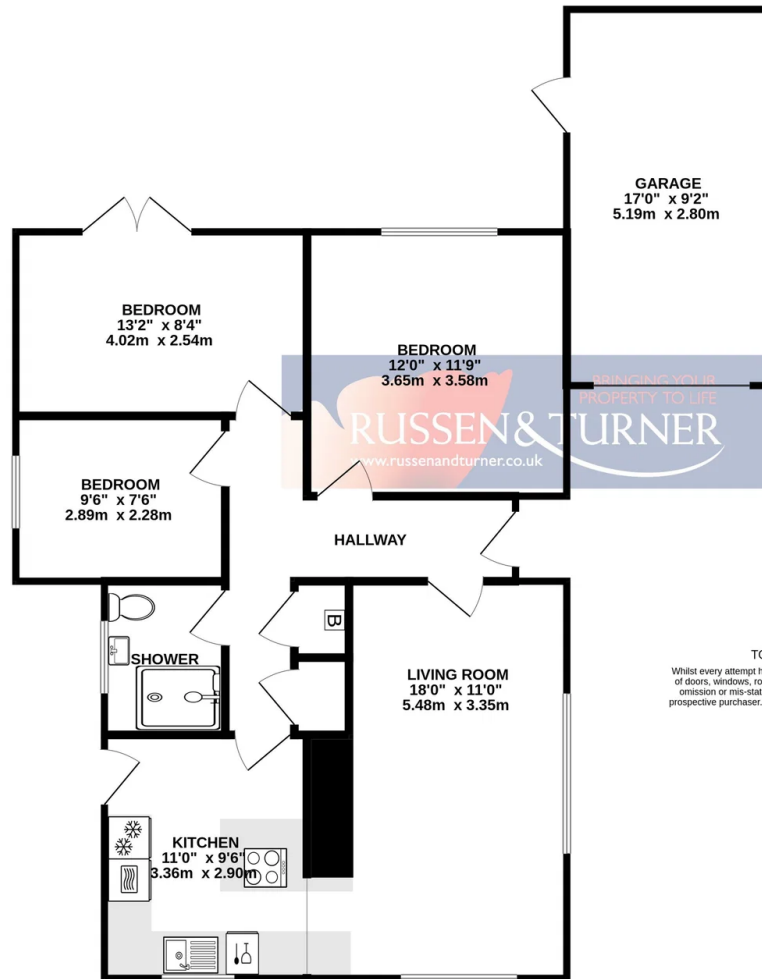

TOTAL FLOOR AREA : 907 sq.ft. (84.2 sq.m.) approx.

Whilst every attempt has been made to ensure the accuracy of the floorplan contained here, measurements of doors, windows, rooms and any other items are approximate and no responsibility is taken for any error, omission or mis-statement. This plan is for illustrative purposes only and should be used as such by any prospective purchaser. The services, systems and appliances shown have not been tested and no guarantee as to their operability or efficiency can be given.
Made with Metropix ©2026