



Flat 5

Weymouth Terrace | | London | E2 8LT

Offers In The Region Of £335,000



STRETTONS

## Key features

- Two Bedroom Split Level Maisonette
- Sold On A Chain Free Basis
- Two Double Bedrooms
- Spacious Communal Gardens
- Private Balcony
- In Need of Refurbishment Throughout
- Communal Entrance with Telephone Entry System for Added Security
- 89 Years Remaining on Lease
- £9 Ground Rent P.A.
- £2365.58 Service Charge P.A.

## Description

A spacious two-bedroom split-level maisonette offered to the market on a chain free basis, enviably located in the heart of vibrant Bethnal Green, E2. Occupying a well-connected yet peaceful residential setting, this property presents an exciting opportunity for first-time buyers, investors, or those seeking a project to modernise and add value.

## Directions





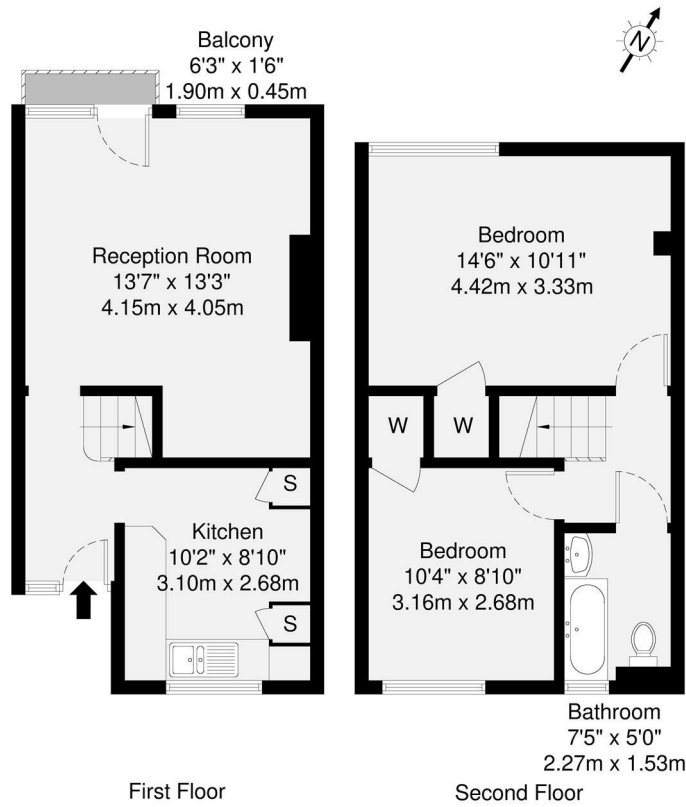

GROSS INTERNAL AREA (GIA)  
The footprint of the property  
65.5 sq m / 706 sq ft

TOTAL STORAGE SPACE  
Storage and wardrobe total area  
2.2 sq m / 23 sq ft

EXTERNAL FEATURES  
Garden, Balcony, Terrace, Verandah etc.  
0.8 sq m / 8 sq ft

RESTRICTED HEAD HEIGHT  
Lower than area under 1.9m  
0.0 sq m / 0.0 sq ft

Disclaimer: Floorplan measurements are approximate and are for illustrative purposes only. While we do not doubt the floorplan accuracy and completeness, you or your advisors should conduct a careful, independent investigation of the property in respect of monetary valuation.

Maison  
VUE

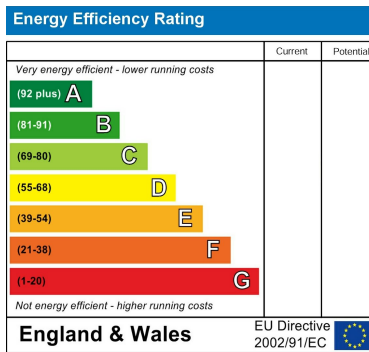

Council Tax Band **B**    EPC Rating



69 Paul Street  
London  
EC2A 4NG  
020 7637 4000

bryn.nettle@strettons.co.uk