



Ground Floor Flat, Nutbeem Road, Eastleigh. SO50 5JT

welcome to

Ground Floor Flat, Nutbeem Road, Eastleigh

Available to cash buyers only due to the short lease, this ground floor one bedroom maisonette is sold with the freehold and offers rear parking, a private garden area, refreshed decor, new doors and EICR in place. Ideal investment with scope to add value.



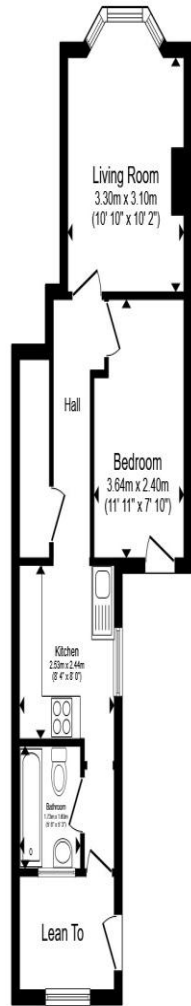

Ground Floor

Total floor area 41.9 m² (451 sq.ft.) approx

This floor plan is for illustrative purposes only. It is not drawn to scale. Any measurements, floor areas (including any total floor area), openings and orientation are approximate. No details are guaranteed, they cannot be relied upon for any purpose and they do not form part of any agreement. No liability is taken for any error, omission or misstatement. A party must rely upon its own inspection(s). Powered by www.propertybox.io



Auctioneer's Comments

This property is offered through Modern Method of Auction. Should you view, offer or bid your data will be shared with the Auctioneer, iamsold Limited. This method requires both parties to complete the transaction within 56 days, allowing buyers to proceed with mortgage finance (subject to lending criteria, affordability and survey). The buyer is required to sign a reservation agreement and make payment of a non-refundable Reservation Fee of 4.5% of the purchase price including VAT, subject to a minimum of £6600.00 including VAT. This fee is paid in addition to purchase price and will be considered as part of the chargeable consideration for the property in the calculation for stamp duty liability. Buyers will be required to complete an identification process with iamsold and provide proof of how the purchase would be funded. The property has a Buyer Information Pack containing documents about the property. The documents may not tell you everything you need to know, so you must complete your own due diligence before bidding. A sample of the Reservation Agreement and terms and conditions are contained within this pack. The buyer will also make payment

of no more than £349 inc. VAT towards the preparation cost of the pack. Please confirm exact costs with the auctioneer. The estate agent and auctioneer may recommend the services of other providers to you, in which they will be paid for the referral. These services are optional, and you will be advised of any payment, in writing before any services are accepted. Listing is subject to a start price and undisclosed reserve price that can change.

Porch

Entrance Hall

Bathroom

3' 8" x 5' 3" (1.12m x 1.60m)

Kitchen

8' 4" x 8' (2.54m x 2.44m)

Hallway

Bedroom

11' 11" x 7' 10" (3.63m x 2.39m)

Living Room

10' 10" x 10' 2" (3.30m x 3.10m)

Garden

Parking

welcome to

Ground Floor Flat, Nutbeem Road, Eastleigh

- Sale by Modern Auction (T&Cs apply)
- Subject to an undisclosed Reserve Price
- Buyers fees apply
- CASH BUYERS ONLY
- SOLD WITH FREEHOLD

Tenure: Leasehold EPC Rating: D

Council Tax Band: A Service Charge: Ask Agent

Ground Rent: Ask Agent

Directions to this property:

Fox and Sons Estate Agents Eastleigh

44 Market St, Eastleigh SO50 5RA

Head towards Regal Walk

Turn left onto Wells PI

At the roundabout, take the 2nd exit onto Southampton Rd/A335

Keep right to continue towards Blenheim Rd

At the roundabout, take the 2nd exit onto Blenheim Rd

Turn left onto Nutbeem Rd and your destination will be on the right



Please note the marker reflects the postcode not the actual property

view this property online fox-and-sons.co.uk/Property/ELH106584

This is a Leasehold property with details as follows; Term of Lease 99 years from 08 Jan 1990. Should you require further information please contact the branch. Please Note additional fees could be incurred for items such as Leasehold packs.



Property Ref:

ELH106584 - 0007

1. MONEY LAUNDERING REGULATIONS Intending purchasers will be asked to produce identification documentation at a later stage and we would ask for your co-operation in order that there is no delay in agreeing the sale. 2. These particulars do not constitute part or all of an offer or contract. 3. The measurements indicated are supplied for guidance only and as such must be considered incorrect. Potential buyers are advised to recheck measurements before committing to any expense. 4. We have not tested any apparatus, equipment, fixtures or services and it is in the buyers interest to check the working condition of any appliances. 5. Where an EPC, or a Home Report (Scotland only) is held for this property, it is available for inspection at the branch by appointment. If you require a printed version of a Home Report, you will need to pay a reasonable production charge reflecting printing and other costs. 6. We are not able to offer an opinion either written or verbal on the content of these reports and this must be obtained from your legal representative. 7. Whilst we take care in preparing these reports, a buyer should ensure that his/her legal representative confirms as soon as possible all matters relating to title including the extent and boundaries of the property and other important matters before exchange of contracts.

fox & sons



023 8061 8522



Eastleigh@fox-and-sons.co.uk



44 Market Street, EASTLEIGH, Hampshire, SO50 5RA



fox-and-sons.co.uk