



**Stable Barn, Venn Farm  
Brixton  
Plymouth  
PL8 2AX**

**Guide Price £229,950**

  
MILLINGTON TUNNICLIFF

# Stable Barn Venn Farm Brixton Plymouth PL8 2AX

## FLOORPLAN

### Ground Floor

Approx. 28.9 sq. metres (310.6 sq. feet)



### First Floor

Approx. 28.9 sq. metres (309.7 sq. feet)

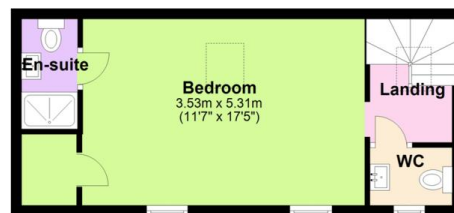

Total area: approx. 57.6 sq. metres (620.3 sq. feet)



1



1



1



A



EPC

C 73



620.3  
SQFT

## Guide Price £229,950

### SUMMARY

A character stable conversion set within the heart of the popular South Hams village of Brixton. Accommodation comprises of a spacious open plan living/dining/kitchen and study/lobby on the ground floor, together with landing, WC, bedroom and en suite shower/WC on the upper floor. The property boasts a wealth of charm and offers oak internal joinery work, an arrow slit window and modern benefits to include gas central heating and double glazing. Externally there is an enclosed rear garden and parking to the front for two vehicles. No chain. EPC C 73.

En Suite Shower/WC And Separate WC | No Chain | Enclosed Rear Garden | Off Road Parking For 2 vehicles | Oak Internal Joinery Work | Integrated Kitchen Appliances | Gas Central Heating | Double Glazing | Vaulted Ceilings To Upper Floors | Character Stable Conversion

### CONTACT

19 Fore Street

Ivybridge

Devon

PL21 9AB

### EMAIL

[info@millingtontunnicliff.co.uk](mailto:info@millingtontunnicliff.co.uk)

### TEL

01752 896020

[www.millingtontunnicliff.co.uk](http://www.millingtontunnicliff.co.uk)