



**Connells**

Dunvegan House Garlands Road  
Redhill



Situated moments from the town centre and a short walk to the mainline train station, this well-appointed purpose-built ground floor apartment offers a superb lifestyle opportunity.

Upon entry, the hallway provides a welcoming introduction to the home with space for coats and shoes, setting the tone for the accommodation beyond. From here, you are drawn into the heart of the property—a bright and airy open-plan living and dining space. This sociable area is bathed in natural light from two front facing windows and is ideal for both relaxation and entertaining.

The living space seamlessly connects to a contemporary fitted kitchen, thoughtfully designed with clean lines. A central peninsula divides the kitchen from the living area and is topped with a breakfast bar, providing an informal dining solution that enhances the flow and functionality of the space.

The double bedroom is quietly positioned and offers excellent proportions, with ample space to accommodate a range of bedroom furniture. Its layout allows for a comfortable dressing area or home working nook, if desired, and enjoys a peaceful aspect ideal for restful nights.

Completing the internal accommodation is a smartly finished bathroom, fitted with a modern white suite including a bath with shower over, a vanity unit with basin, and a low-level WC.

Externally, the apartment benefits from a designated parking space located to the rear of the development—a valuable feature in such a central location.



**Entrance Hallway**

**Kitchen/Dining/Living Room**

17' 4" x 13' 11" ( 5.28m x 4.24m )

**Double Bedroom**

14' 1" Into box bay x 9' 11" ( 4.29m Into box bay x 3.02m )

**Bathroom**

6' 10" x 5' 6" ( 2.08m x 1.68m )

**Outside**

**One Allocated Parking Space**







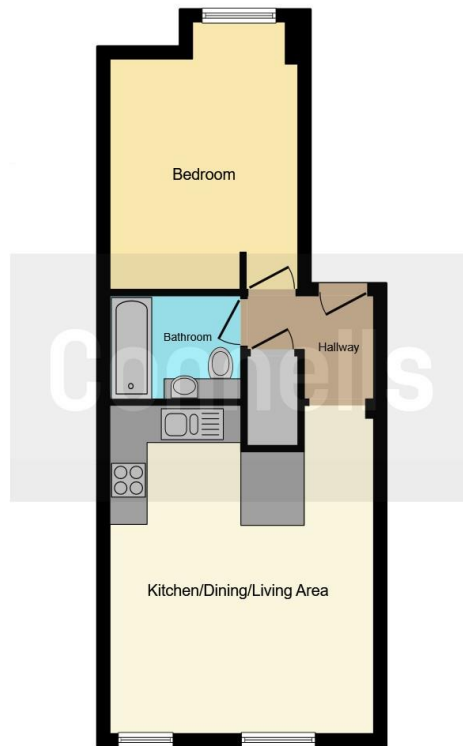

This floor plan is for illustrative purposes only. It is not drawn to scale. Any measurements, floor areas (including any total floor area), openings and orientation are approximate. No details are guaranteed, they cannot be relied upon for any purpose and they do not form part of any agreement. No liability is taken for any error, omission or misstatement. A party must rely upon its own inspection(s). Powered by [www.focalagent.com](http://www.focalagent.com)

To view this property please contact Connells on

**T 01737 774 277**  
**E [redhill@connells.co.uk](mailto:redhill@connells.co.uk)**

43 Station Road  
REDHILL RH1 1QH

EPC Rating: D Council Tax  
Band: C

Service Charge:  
1823.76

Ground Rent:  
Ask Agent

Tenure: Leasehold

**view this property online [connells.co.uk/Property/RED408241](http://connells.co.uk/Property/RED408241)**

This is a Leasehold property with details as follows; Term of Lease 99 years from 19 Dec 2016. Should you require further information please contact the branch. Please Note additional fees could be incurred for items such as Leasehold packs.



1. MONEY LAUNDERING REGULATIONS Intending purchasers will be asked to produce identification documentation at a later stage and we would ask for your co-operation in order that there will be no delay in agreeing the sale. 2. These particulars do not constitute part or all of an offer or contract. 3. The measurements indicated are supplied for guidance only and as such must be considered incorrect. Potential buyers are advised to recheck measurements before committing to any expense. 4. We have not tested any apparatus, equipment, fixtures, fittings or services and it is in the buyers interest to check the working condition of any appliances.

Connells Residential is registered in England and Wales under company number 1489613, Registered Office is Cumbria House, 16-20 Hockliffe Street, Leighton Buzzard, Bedfordshire, LU7 1GN. VAT Registration Number is 500 2481 05.

**See all our properties at [www.connells.co.uk](http://www.connells.co.uk) | [www.rightmove.co.uk](http://www.rightmove.co.uk) | [www.zoopla.co.uk](http://www.zoopla.co.uk)**

Property Ref: RED408241 - 0005