



**SALES**

**LETTINGS**

**MANAGEMENT**

[chiswick@tatepartnership.co.uk](mailto:chiswick@tatepartnership.co.uk)

**020 8996 0000**

**TATEPARTNERSHIP.CO.UK**



**Kew Bridge Road**

**£1,750 pcm**

A Modern One Bedroom Second Floor Apartment (Lift), within this Attractive Development fashioned from an 18th Century Coaching Inn. Rated B (EPC) for Energy Cost Efficiency, with modern double glazing and underfloor heating, the accommodation has; entrance hall with good storage, open plan living/dining/kitchen, fitted double bedroom, bathroom. Peacefully positioned to the rear of the building, whilst also benefitting from stepping out for those picturesque walks along the Thames. Enjoy the local bustling Cafe, Restaurant and Gastro culture. Available now, part furnished.

# Kew Bridge Road

## Floor Plan

Approximate gross internal area  
47 sq m / 510 sq ft

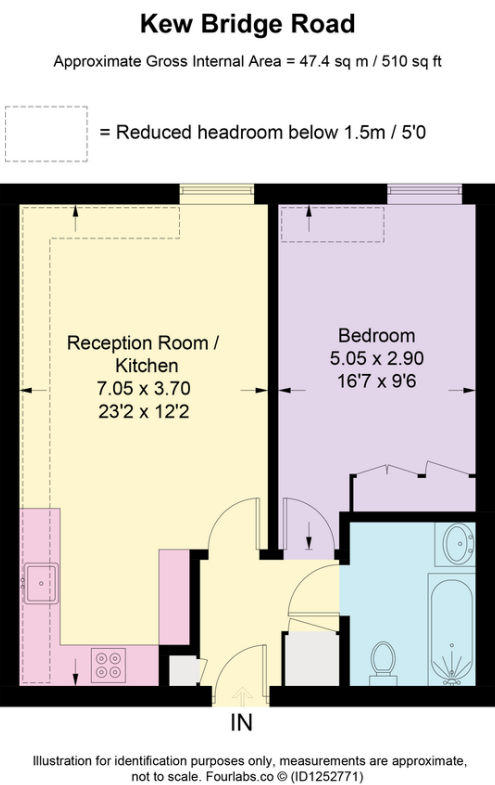

## EPC

Score	Energy rating	Current	Potential
92+	A		
81-91	B	82 B	82 B
69-80	C		
55-68	D		
39-54	E		
21-38	F		
1-20	G		