

GROUND FLOOR
404 sq.ft. (37.5 sq.m.) approx.

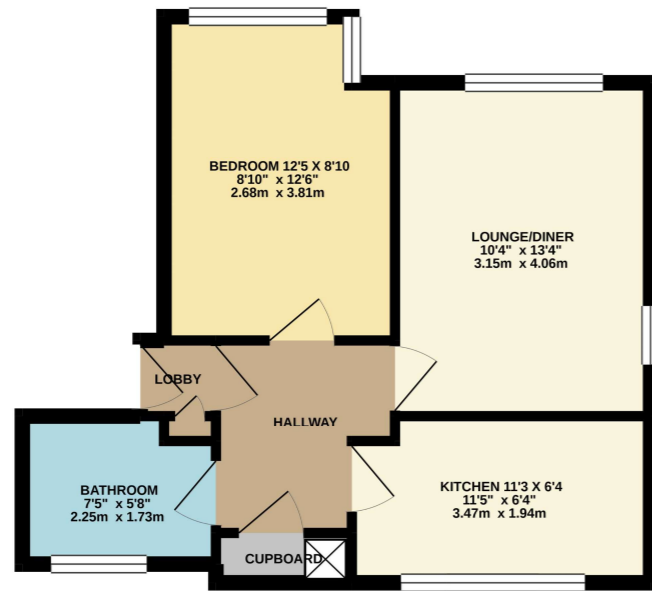

RYDE DRIVE
TOTAL FLOOR AREA - 404 sq.ft. (37.5 sq.m.) approx.
Whilst every attempt has been made to ensure the accuracy of the floorplan contained here, measurements of floors, windows, rooms and any other items are approximate and no responsibility is taken for any error, omission or mis-statement. This plan is for illustrative purposes only and should be used as such by any prospective purchaser. The services, systems and appliances shown have not been tested and no guarantee as to their condition or efficiency can be given. Made with SketchUp 2022

THINKING OF SELLING OR TRYING TO SELL?

- Family Firm Established since 1980
- Extensive Buyer Register
- All Homes Visibly Marketed from Team Agencies in Essex & LONDON
- Accompanied Viewings
- Excellent photography & Floorplans
- Highly Experienced Agency, 1000's successfully SOLD



Energy Efficiency Rating		Current	Potential
Very energy efficient - lower running costs			
(92-100)	A		
(81-91)	B		
(69-80)	C		
(55-68)	D		
(39-54)	E		
(21-38)	F		
(1-20)	G		
Not energy efficient - higher running costs			
		72	80

England, Scotland & Wales EU Directive 2002/91/EC



Ryde Drive, Stanford-Le-Hope, Essex, SS17 0DR | Guide Price £170,000 to £190,000

- 963 year lease remaining
- 1 bedroom first floor flat
- Stylish modern bathroom
- Allocated parking
- Lounge/diner + separate kitchen
- Close by Train Station



19 Kings Parade, King Street, Stanford-le-Hope, Essex, SS17 0HP
01375 676655 sales@johncottis.co.uk
www.johncottis.co.uk

Registered Proprietors Temp-Green LTD., Trading as John Cottis & Co. Registered in England No. 1534107
Registered Office: 21 Lodge Lane, Grays, Essex, RM17 5RY

The Consumer Protection from Unfair Trading Regulations 2008 (CPRs). These details are for guidance only and complete accuracy cannot be guaranteed. If there is any point, which is of particular importance, verification should be obtained. They do not constitute a contract or part of a contract. All measurements are approximate. No guarantee can be given with regard to planning permissions or fitness for purpose. No apparatus, equipment, fixture or fitting has been tested. Items shown in photographs are NOT necessarily included. Interested Parties are advised to check availability and make an appointment to view before travelling to see a property.

Guide Price: £170,000 to £190,000. 963 years lease approx and a few minutes walk to Train Station from this highly impressive first floor 1 bedroom home with stylish presentation, allocated parking, lounge/diner + separate kitchen. Don't miss out!

Entrance Hall: 7'4" x 5'8" (2.24m x 1.73m)
Vinyl flooring. Built-in cupboard housing water tank and providing storage space. Entrance door handset.

Lounge/Diner: 13'4" x 10'4" (4.06m x 3.15m)
Stylish lounge presentation with fitted carpet, wall mounted heater, double glazed window to dual aspects. Coved cornice to ceiling.

Bedroom: 12'6" x 8'10" max (3.8m x 2.7m max)
Fitted carpet. Coved cornice to ceiling, double glazed window. Well presented. Built-in wardrobes with mirror fronted sliding doors.

Bathroom: 7'5" x 5'8" (2.26m x 1.73m) Stylish modern bathroom design, with white suite with bath, wc, wash hand basin and electric powered shower system complimented with contrasting wall tile and floor tiling. Double glazed window.

Kitchen: 11'5" x 6'4" (3.48m x 1.93m) Spacious kitchen located separately from lounge and is well presented with range of base and eye level units with work surfaces, tiled splash backs, plumbing for washing machine, two double glazed windows.

Allocated Parking: We are advised 1 allocated parking space and 2 communal visitor spaces.

Location: The home is well positioned for ready Train Station and town shops plus A13 road links. See map for further information.

Lease: We are advised approx 963 years remaining (Solicitors to verify).

Council Tax Band: 'B'

