



29a Amersham Hill, High Wycombe, Buckinghamshire, HP13 6NU

Asking Price | £1,650

## Property Description

AVAILABLE FROM SEPTEMBER

A well-presented 3-bedroom split-level apartment, ideally suited to three sharers or students, located just a short walk from High Wycombe train station.

The property benefits from a modern fitted kitchen and spacious accommodation throughout, comprising: a private entrance, kitchen with a range of appliances, a modern fitted bathroom, two bedrooms, and stairs leading down to a large basement bedroom.

Additional features include an outside patio area and residents' parking (offered on a first-come, first-served basis). Early internal viewing is strongly recommended to fully appreciate the space and standard of accommodation on offer.

Available early September on a part-furnished basis.

EPC RATING E

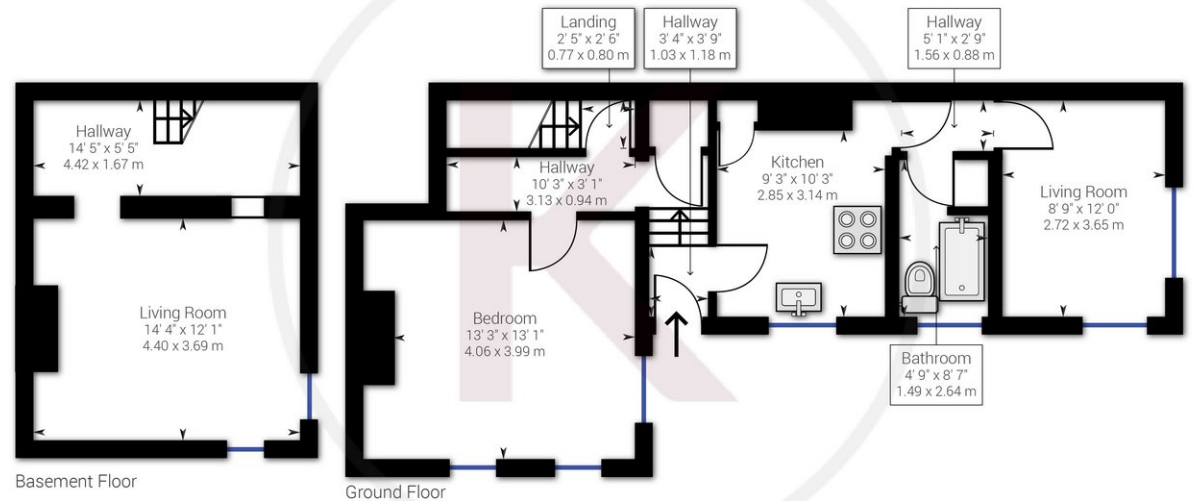

Approximate net internal area: 800.68 ft<sup>2</sup> / 74.39 m<sup>2</sup>  
While every attempt has been made to ensure accuracy, all measurements are approximate, not to scale. This floor plan is for illustrative purpose only and should be used as such by any prospective tenant or purchaser.

Powered by Giraffe360

Kingshills Estate Agents  
C1C Comet Studios  
Amersham  
Buckinghamshire  
HP7 0PX

01494 939868  
hello@kingshills.co.uk  
kingshills.co.uk

Agents Note: Whilst every care has been taken to prepare these particulars, they are for guidance purposes only. All measurements are for general guidance purposes only and whilst every care has been taken to ensure accuracy, they should not be relied upon and potential buyers/tenants are advised to recheck the measurements