



Disc Zone
P
Mon-Fri
8am-8pm
Sat
8am-6pm
2 hours
No return
within 1 hour
Permit holders
exempt

**Hayward
Tod**

2 bed End Terrace House | 34 York Street | Carlisle | CA2 5UJ

Guide Price £115,000





An attractive double fronted end terrace house conveniently located on a quiet side road handy for the city centre and the hospital. Generous main double bedroom, double bedroom two and first floor bathroom. Two good reception rooms. Fitted kitchen. Enclosed west facing yard.

ACCOMMODATION SUMMARY

Lobby and stairs | Living room | Sitting room | Kitchen | Store cupboard | First floor landing | Front double bedroom one | Front double bedroom two | Bathroom | West facing enclosed yard | All mains services | Gas central heating | EPC rating - D | Council Tax Band - A | Freehold

APPROXIMATE MILEAGES

Aldi 0.2 (5 minute walk) | Sainsburys 0.5 | Central Carlisle -



West Coast Mainline Station 0.9 | Solway Coast AONB - Bowness on Solway 12.8 | Lake District National Park - Caldbeck 12.7, Pooley Bridge Ullswater 24.8 | Hadrian's wall UNESCO Site - Birdoswald Fort 18.2 | Newcastle International Airport 56.8

WHY YORK STREET?

The property is conveniently situated on a quiet side road near Carlisle's most famous historic, Grade II listed landmark Dixon's Chimney built in 1836. Excellent amenities within an easy walking distance including public transport, Sainsburys and Aldi. Walk to parkland and the city centre where a comprehensive range of shops, pubs and restaurants await. Handy for main road network for M6, Lake District, Solway Coast and West Cumbria.

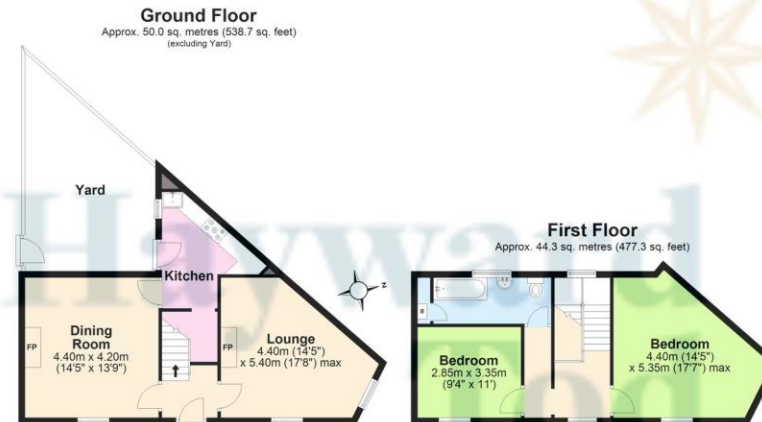

Contact

6 Paternoster Row,
Carlisle Cumbria CA3 8TT

01228 810 300
info@haywardtdod.co.uk
haywardtdod.co.uk

Agents note

Whilst every care has been taken to prepare these sales particulars, they are for guidance purposes only. All measurements are

approximate and are for general guidance purposes only and whilst every care has been taken to ensure their accuracy, they should not be relied upon and potential buyers are advised to recheck the measurements.