



Gordon Hill, Enfield, EN2 0QT

Not for marketing purposes INTERNAL USE ONLY

welcome to
Gordon Hill, Enfield

Barnfields are extremely pleased to offer this spacious late Victorian four bedroom house of charm and character, in a most sought after turning, within a short walking distance of Gordon Hill Rail Station (Moorgate Line) and close to the Wren and One Degree Academy Schools, local shops on Chase Side and Lancaster Road. Enfield Town multiple shopping centre is also close at hand.

The superb extended property features:-



Entrance Lobby

Attractive front door incorporating stained glass, ceramic tiled floor.

Entrance Hall

Ceramic tiled floor, radiator.

Lounge / Dining Room

26' 6" x 10' 4" (8.08m x 3.15m)

Handsome cast iron fireplace with living flame gas fire and tiled slips, fitted carpet, bay window with shutters, three column radiators, picture rail, understairs storage cupboard, double glazed casement door to garden.

Kitchen

10' 6" x 6' 6" (3.20m x 1.98m)

Comprehensively fitted comprising base units with worktops, inset gas hob unit, built-in oven, integrated one and a half bowl steel sink unit, matching wall cabinets, plumbing for washing machine and dishwasher, radiator/heated towel rail, extractor fan, door to garden, wall mounted combination gas central heating boiler.

First Floor

Landing

Fitted carpet.

Bedroom One

13' 9" x 11' 6" (4.19m x 3.51m)

Fitted carpet, radiator, range of built-in wardrobe cupboards.

Bedroom Two

12' 6" x 8' 1" (3.81m x 2.46m)

Fitted carpet, radiator.

Bathroom / WC

Panelled bath with separate rain shower, shower screen, pedestal wash hand basin, low flush WC (white suite), ceramic tiled floor, part tiled walls, double airing cupboard.

Second Floor

Landing

Fitted carpet.

Cloakroom / WC

Low flush WC, bracket wash hand basin, ceramic tiled floor, half tiled walls.

Bedroom Three

13' 8" x 8' (4.17m x 2.44m)

Fitted carpet, radiator, fireplace, bay window.

Bedroom Four

13' 1" x 8' 1" (3.99m x 2.46m)

Fitted carpet, radiator.

Outside

Front Garden

Brick paved providing off-street parking.

Rear Garden

Approximately 140' south facing rear garden with patio and private seating area, laid to lawn, water tap, vegetable garden and green house to rear.



view this property online barnfields.co.uk/Property/ENF105772







welcome to

Gordon Hill, Enfield

- Four Good Sized Bedrooms
- Sash Style Double Glazing
- 140' South Facing Rear Garden
- Off-Street Parking To Front
- Spacious Attractive Lounge / Diner

Tenure: Freehold EPC Rating: D

Council Tax Band: E

£700,000



Please note the marker reflects the postcode not the actual property

check out more properties at [barnfields.co.uk](https://www.barnfields.co.uk)



Property Ref:
ENF105772 - 0002

1. MONEY LAUNDERING REGULATIONS Intending purchasers will be asked to produce identification documentation at a later stage and we would ask for your co-operation in order that there is no delay in agreeing the sale. 2. These particulars do not constitute part or all of an offer or contract. 3. The measurements indicated are supplied for guidance only and as such must be considered incorrect. Potential buyers are advised to recheck measurements before committing to any expense. 4. We have not tested any apparatus, equipment, fixtures or services and it is in the buyers interest to check the working condition of any appliances. 5. Where an EPC, or a Home Report (Scotland only) is held for this property, it is available for inspection at the branch by appointment. If you require a printed version of a Home Report, you will need to pay a reasonable production charge reflecting printing and other costs. 6. We are not able to offer an opinion either written or verbal on the content of these reports and this must be obtained from your legal representative. 7. Whilst we take care in preparing these reports, a buyer should ensure that his/her legal representative confirms as soon as possible all matters relating to title including the extent and boundaries of the property and other important matters before exchange of contracts.

Barnfields is a trading name of Sequence (UK) Limited which is registered in England and Wales under company number 4268443, Registered Office is Cumbria House, 16-20 Hockliffe Street, Leighton Buzzard, Bedfordshire, LU7 1GN. VAT Registration Number is 500 2481 05.

Gordon Hill, Enfield, EN2

Approximate Area = 1083 sq ft / 100.6 sq m
Limited Use Area(s) = 14 sq ft / 1.3 sq m
Outbuilding = 52 sq ft / 4.8 sq m
Total = 1149 sq ft / 106.7 sq m
For identification only - Not to scale

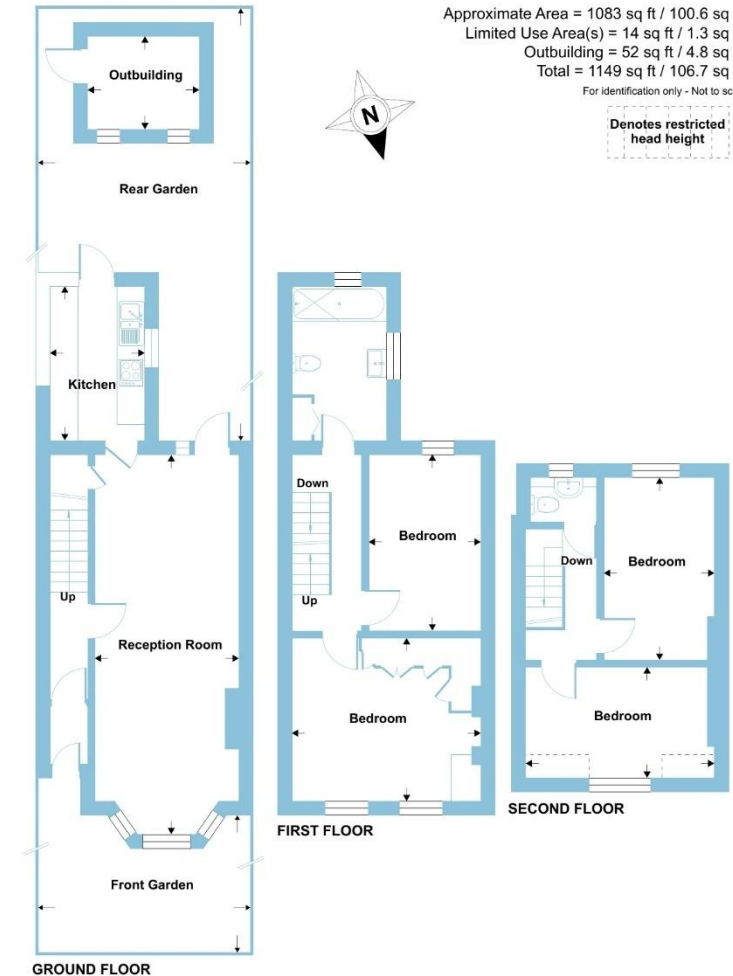

Floor plan produced in accordance with RICS Property Measurement 2nd Edition, Incorporating International Property Measurement Standards (IPMS2 Residential). © nichecom 2026. Produced for Barnard Marcus. REF: 1438068



020 8363 3394



info@barnfields.com



1a Windmill Hill, Enfield, Middlesex, EN2 6SE



[barnfields.co.uk](https://www.barnfields.co.uk)