



9A Wallingford Road

South Stoke Reading, RG8 0JD

50% Shared Ownership £ 160,000

Discover this beautifully presented & spacious ground floor apartment nestled in the charming village of South Stoke. Boasting a contemporary design and meticulous attention to detail, this apartment offers a perfect blend of comfort and style.

The 9a Wallingford Road comprises of spacious living area is filled with natural light creating a warm and inviting area with French doors leading out to the fully enclosed garden, shaker style kitchen with integrated appliances, two double bedrooms and good sized bathroom.

Other points of interest;

- Installed OHME e-pod EV charger accessible for parking spot (Octopus)
- Kitchen white goods all new which includes AEG washing machine, AEG cooker, Beko dishwasher
- Cotswold stone flooring in kitchen, engineered oak flooring in both bedrooms & brand new carpet hallway and living room
- Updated bathroom sink & basin and LED mirror
- Outside tap installed
- Outside gates installed allowing field access & security
- Shed is equipped with electricity point
- Modernised oak shelving units throughout property
- Two allocated parking spaces

- Full Market Price £ 320,000
- Shares Available 50% - 100%
- Current Monthly Rent £ 359.26
- Current Monthly Service Charge £ 18.67
- Current Monthly Ground Rent £ 8.33
- Lease Term Remaining 110 Years
- Beautifully Presented Ground Floor Apartment
- Two Allocated Parking Spaces
- Pretty Fully Enclosed Garden 5.7 x 5.5m
- Gas Central Heating



Floor Plan

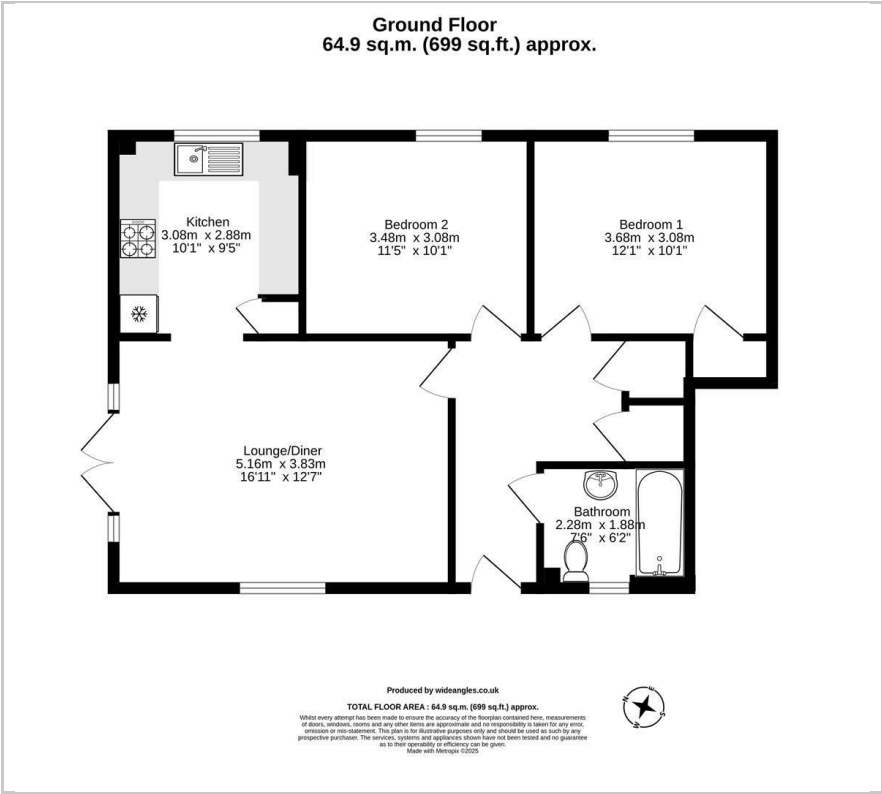

Area Map



Energy Efficiency Graph



These particulars, whilst believed to be accurate are set out as a general outline only for guidance and do not constitute any part of an offer or contract. Intending purchasers should not rely on them as statements of representation of fact, but must satisfy themselves by inspection or otherwise as to their accuracy. No person in this firm's employment has the authority to make or give any representation or warranty in respect of the property.