

19 -19a Chester Road, Castle, Northwich, Cheshire, CW8 1HA
£175,000

Situated in a popular residential area, this large commercial unit is currently trading as a successful hair salon and benefits from a separate two bedroom flat above with private access. Benefitting from uPVC double glazing and gas central heating, the salon comprises of reception area, four separate trading areas, kitchen and toilet facilities, whilst the flat comprises entrance hall, lounge, kitchen and two bedrooms.

For an internal viewing please contact Coulby Conduct Northwich Office on 01606 352220.

Accommodation

Ground Floor

Reception Area: 11'9" x 7'3"

Trading Area 1: 10'9" x 10'4"

Trading Area 2: 9'3" x 6'0"

Trading Area 3: 16'10" x 11'11"

Trading Area 4/Utility: 11'10" x 9'10"



Flat

Separate Access Stairs.

Entrance Hall:

Lounge: 13'10" x 11'1"

Kitchen: 12'3" x 9'9"

Bedroom One: 11'0" x 10'11"

Bedroom Two: 15'7" x 8'9"

Bathroom: 8'5" x 7'1"

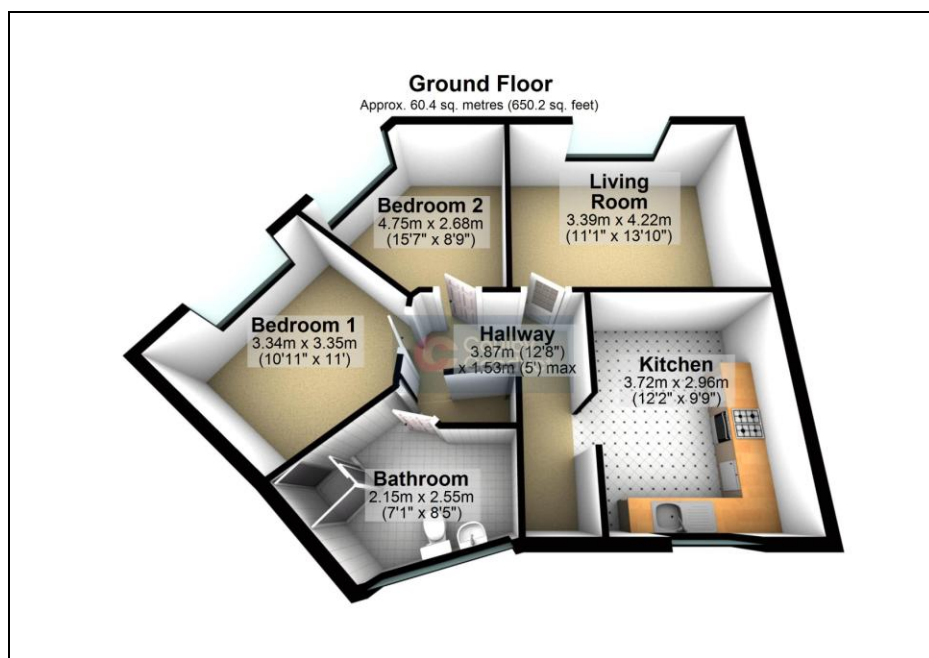

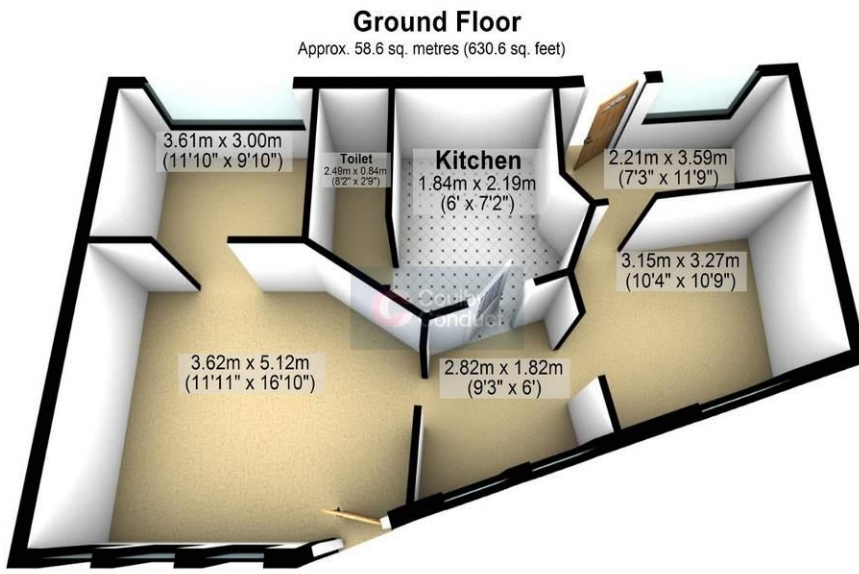

Total area: approx. 58.6 sq. metres (630.6 sq. feet)

Please note that we have not tested any apparatus, equipment, fixtures, fittings or services, and so cannot verify they are in working order or fit for their purpose.

Whilst these particulars have been prepared in good faith and are believed to be correct, they are intended for the general guidance only of prospective Purchasers and should not be founded on under any circumstances. All measurements are approximate and the property is sold in its present state of repair.

Furthermore solicitors should confirm moveable items described in the sales particulars are, in fact, included in the sale since circumstances do change during marketing or negotiations. A final inspection prior to exchange of contracts is also recommended.

YOUR HOME IS AT RISK IF YOU DO NOT KEEP UP REPAYMENTS ON A MORTGAGE OR OTHER LOAN SECURED ON IT

Coulby Conduct Estate Agents make introductions for Financial Services business to Coulby Conduct financial services, regulated by the Financial Services Authority.