



Stoneman Way, Ramsey Huntingdon
£425,000 Freehold

**Sharman
Quinney**

Key Features



- Stunning 20 FOOT Kitchen/Diner
- Scenic Views Over Open Fields
- Desirable Location Off Biggin Lane
- Built-in Storage in ALL Bedrooms
- Separate Utility Room

Ground Floor

Entrance Hall
Leading to

Study - 9'4" Max x 8'2" (2.84m Max x 2.49m)
Multifunctional room with window to front.

Lounge - 11'8" x 18'1" Max (3.56m x 5.51m)
Window to side and rear with French Doors
leading to the garden.

Kitchen/Diner - 12'5" Max x 20'3" (3.78m Max x 6.17m)
Fitted with a beautiful range of base and eye-level
units with a separate Island, bay window to front
and French Doors leading to the garden.



Utility Room - 5'6" x 7'5" (1.68m x 2.26m)
Rear door to the garden.

Cloakroom

Fitted with a two-piece suite and compromising of a wash hand basin, low-level-WC and window to side.

First Floor

Master Bedroom - 11'8" x 18'3" Max (3.56m x 5.56m max)

Dual aspect windows with built-in wardrobe.

En-Suite

Fitted with a three-piece suite and compromising of a double shower cubicle, wash hand basin, low-level-WC and window to side.

Bedroom 2 - 15'2" + Wardrobe x 9'1" (4.62m + Wardrobe x 2.77m)

Full depth built-in wardrobe with two windows to front.

Bedroom 3 - 11'7" Max x 10'9" (3.53m Max x 3.28m)

Built-in wardrobe with window to rear.

Family Bathroom

Fitted with a four-pieces suite and compromising of a double shower, bath, wash hand basin, low-level-WC and window to rear.



GROUND FLOOR

1ST FLOOR

GARAGE

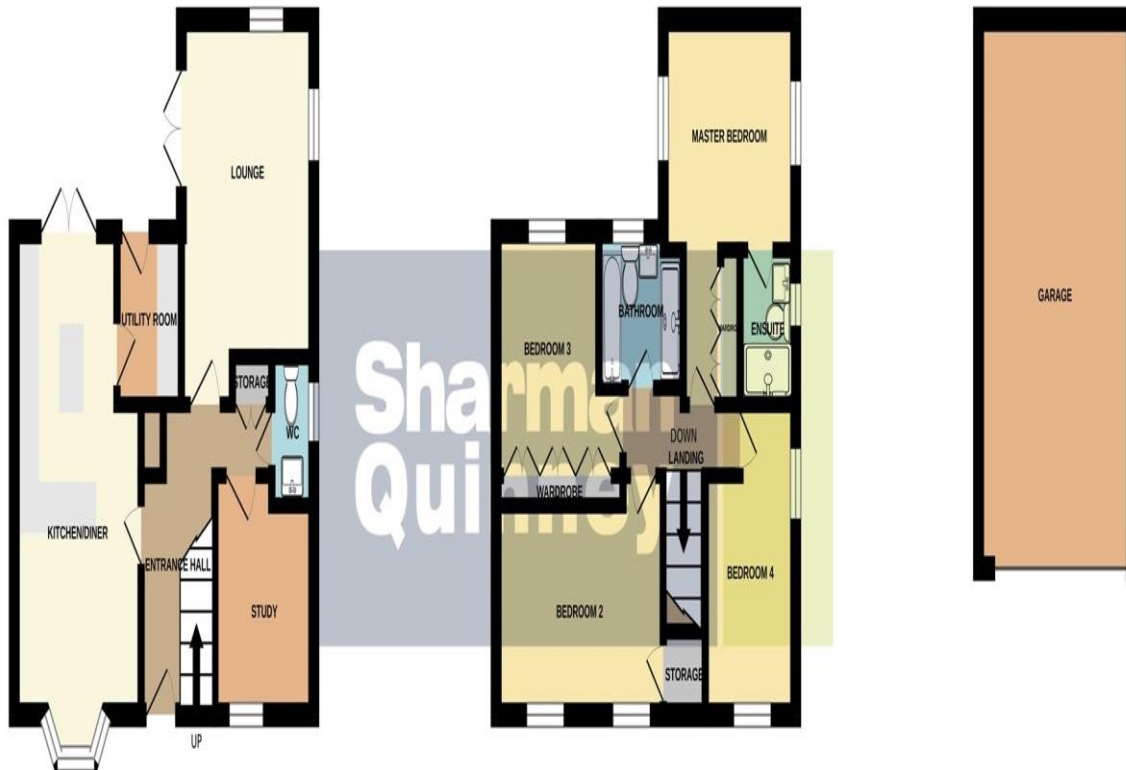

Bedroom 4 - 12'8" Max x 8'1" (3.86m Max x 2.46m)
Built-in storage cupboard with window to front and side.

Outside

The private rear enclosed garden is a blank canvas ready to put your own stamp on. The rear gate provides access to the Garage and off-road parking for multiple cars.

Garage - 10'6" x 20'7" (3.20m x 6.27m)
Up and over roller to front with lighting and electrical sockets.

Whilst every attempt has been made to ensure the accuracy of the floorplan contained here, measurements of doors, windows, rooms and any other items are approximate and no responsibility is taken for any error, omission or mis-statement. This plan is for illustrative purposes only and should be used as such by any prospective purchaser. The services, systems and appliances shown have not been tested and no guarantee as to their operability or efficiency can be given.

Made with Metropix ©2025

To view this property call Sharman Quinney on:
01487 710345

Selling your property?

Contact us to arrange a **FREE** home valuation.

 01487 710345

 17 Great Whyte, Ramsey, HUNTINGDON,
Cambridgeshire, PE26 1HG

 ramsey@sharmanquinney.co.uk

 www.sharmanquinney.co.uk



 SCAN ME



Sharman Quinney Holdings Limited is registered in England and Wales under company number 4174227, Registered Office is Cumbria House, 16-20 Hockliffe Street, Leighton Buzzard, Bedfordshire, LU7 1GN. VAT Registration Number is 500 2481 05.

1: These particulars do not constitute part or all of an offer or contract. 2: The measurements indicated are supplied for guidance only and as such must be considered incorrect. 3: Potential buyers are advised to recheck the measurements before committing to any expense. 4: Sharman Quinney has not tested any apparatus, equipment, fixtures, fittings or services and it is the buyers interests to check the working condition of any appliances. 5: Sharman Quinney has not sought to verify the legal title of the property and buyers must obtain verification from their legal representative. 6: Intending purchasers will be asked to produce identification documentation at a later stage and we would ask your co-operation in order that there will be no delay in agreeing the sale. Ref: RAM204578 - 0001

