



PROPERTY
PERFECTLY PRESENTED

2 Bedrooms

Flat - Purpose Built

£445,000

Located in

London





Ashleigh House Mortlake High

London | | SW14 8SH



Enjoying an enviable riverside setting and just moments from Mortlake Station, this superb two-bedroom ground floor apartment is offered in excellent condition with no onward chain.

Ashleigh House Mortlake High

£445,000 Leasehold



- Two spacious bedrooms
- Excellent transport links
- Well-proportioned layout
- New Long lease (178 years) upon completion
- Chain free
- Riverside location
- Communal Garden
- Low Service charge
- Good local amenities
- Extra storage facilities

Ashleigh House
 Approx Gross Internal Area
 Ground Floor = 46.7 Sq m / 502 Sq Ft
 Store = 1.6 Sq m / 17 Sq Ft
 Total = 48.3 Sq m / 519 Sq Ft

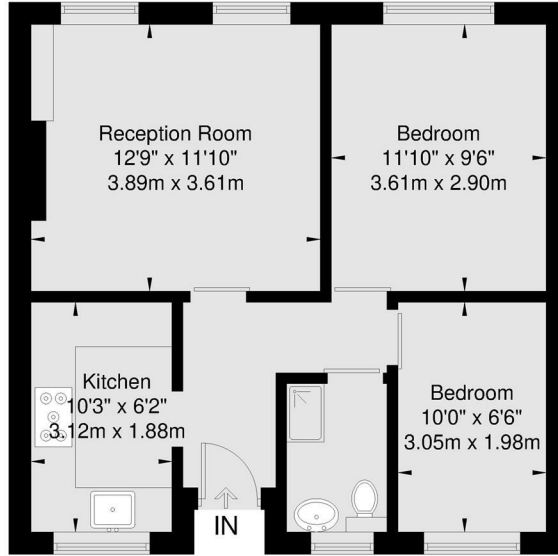
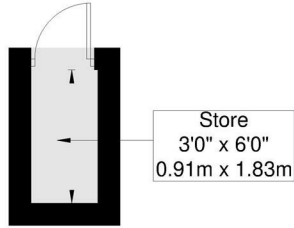

Ground Floor

Viewmedia @ 2026
 Viewmedia.co.uk

Whilst every attempt has been made to ensure the accuracy of this floor plan, measurements of doors, windows and rooms are approximate and no responsibility is taken for any error or omission. This illustration is for identification purpose only. Not drawn to scale, unless stated. Dimensions shown are to the nearest 3" and are to the points indicated by the arrow heads.

EPC Rating: C
Council Tax Band C
Local Authority

Agents Note: Whilst every care has been taken to prepare these particulars, they are for guidance purposes only. All measurements are approximate and are for general guidance purposes only and whilst every care has been taken to ensure their accuracy, they should not be relied upon and potential buyers/tenants are advised to recheck the measurements.

Energy Efficiency Rating		Current	Potential
Very energy efficient - lower running costs			
(92 plus) A			
(81-91) B			
(69-80) C		74	80
(55-68) D			
(39-54) E			
(21-38) F			
(1-20) G			
Not energy efficient - higher running costs			
England & Wales		EU Directive 2002/91/EC	

Leyborne Park
 Kew
 TW9 3HB



jo@teddyproperty.com

02046 384065

30