

Little Bushey Lane

Bushey • Hertfordshire • WD23 4SA

Asking Price: £1,250,000



coopers
est 1986

Little Bushey Lane

Bushey • Hertfordshire • WD23 4SA

A newly built five detached house, designed to the highest specification and situated in Bushey.

Featuring an open plan kitchen, with a light and airy separate living area, five spacious bedroom with three luxury bathrooms and private garden that would be the perfect family home.

Watford High Street and Watford Atria Shopping centre are also a short car journey away, boasting over 130 independent and high street shops. Both Bushey and Watford are well known for their excellent schools, some rated 'Outstanding' by Ofsted 130 Little Bushey Lane is an ideal location to reside for working professionals and young families.

Five spacious bedrooms

Stylish modern kitchen

Luxury bathrooms

Private garden

Modern built

Wooden flooring throughout ground floor

No chain

Downstairs WC & Utilities room

Sought after location

2032 SQ.FT

These particulars are intended as a guide and must not be relied upon as statements of fact. Your attention is drawn to the Important Notice on the last page.





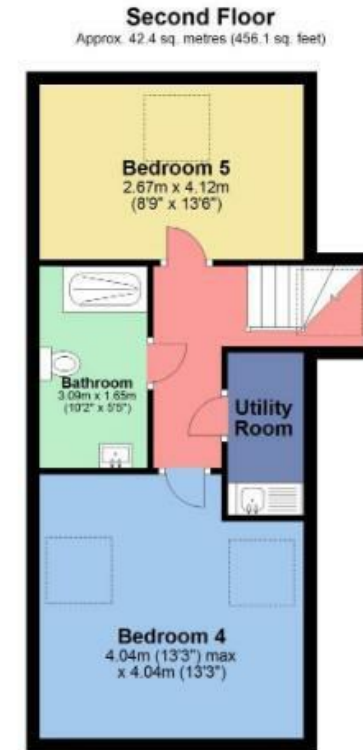
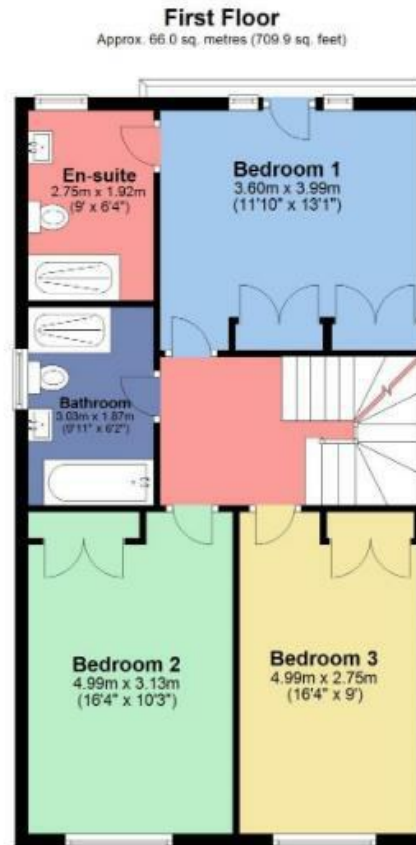
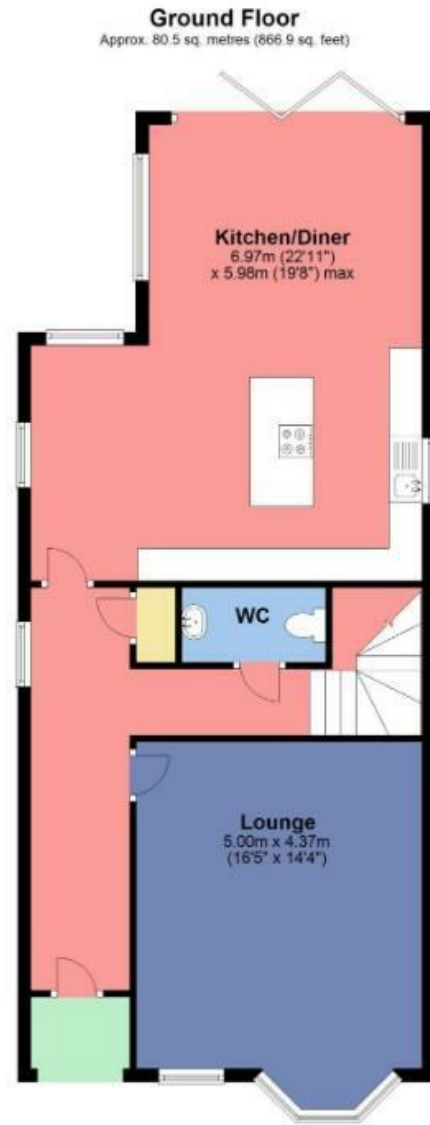

Total area: approx. 188.9 sq. metres (2032.9 sq. feet)

coopers
est 1986

**18 Bridge Street, Pinner,
Middlesex, HA5 3JF**
pinner@coopersresidential.co.uk

CoopersResidential.co.uk

Energy Efficiency Rating		
Very energy efficient - lower running costs	Current	Target
A (92-100)	88	89
B (81-91)		
C (69-80)		
D (55-68)		
E (39-54)		
F (21-38)		
G (1-20)		
Not energy efficient - higher running costs		
England & Wales		
EPC Directive 2002/91/EC		

Important Notice: These particulars, whilst believed to be accurate are set out as a general outline only for guidance and do not constitute any part of an offer or contract. Intending purchasers should not rely on them as statements or representation of fact, but must satisfy themselves by inspection or otherwise has the authority to make or give any representation or warranty in respect of the property.