



# Gilling Court

Belsize Grove, NW3

£2,500 per month  
(£576.92 per week)

A delightful south facing 3rd floor apartment set in this 1920s purpose built block with lift in the heart of Belsize Park with communal gardens. Rent includes Council Tax, gas, internet, communal heating and hot water. Sole Agent.

**CHESTERTONS**



# Gilling Court

## Belsize Grove, NW3

- A Delightful South Facing 3rd Floor Apartment in Purpose Built Block
- 1 Bedroom, 1 Bathroom, Reception, Kitchen
- Lift, Communal Gardens, Rent Includes Communal Heating/Hot Water, Internet, Gas, and Council Tax.
- Situated in the Heart of Belsize Park (Northern Line)



A delightful south facing 3rd floor apartment set in this 1920s purpose built block with lift situated in the heart of Belsize Park. The property has been decorated and boasts communal gardens. Accommodation comprises reception room with ornamental fire place, kitchen, double bedroom with fitted wardrobes, power shower. Rent includes communal heating, gas, Internet and Council Tax. Sole Agent.

**Minimum Term:** 12 months  
**Deposit Required:** £2,884.62  
**Local Authority:** Camden  
**Council Tax Band:** D  
**EPC Rating:** E  
**Furnished**

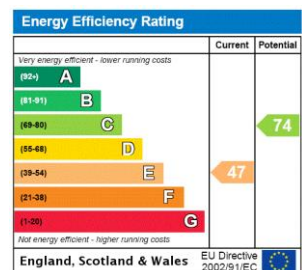

### *Chestertons Hampstead Lettings*

55-56 Hampstead High Street  
 Hampstead  
 London  
 NW3 1QH  
 hampsteadlettingsusers@chestertons.co.uk  
 02077941125  
 chestertons.co.uk

Additional tenant charges apply (fees apply to non-AST tenancies only)  
 Tenancy Agreement Fee: £300  
 References per Tenant/Guarantor: £60  
 Inventory check (approx. £100 – £250 inc. VAT)  
 chestertons.co.uk/property-to-rent/applicable-fees

# Gilling Court Belsize Grove, NW3 4XD

Approx Gross Internal Area = 41.4 sq m / 445 sq ft

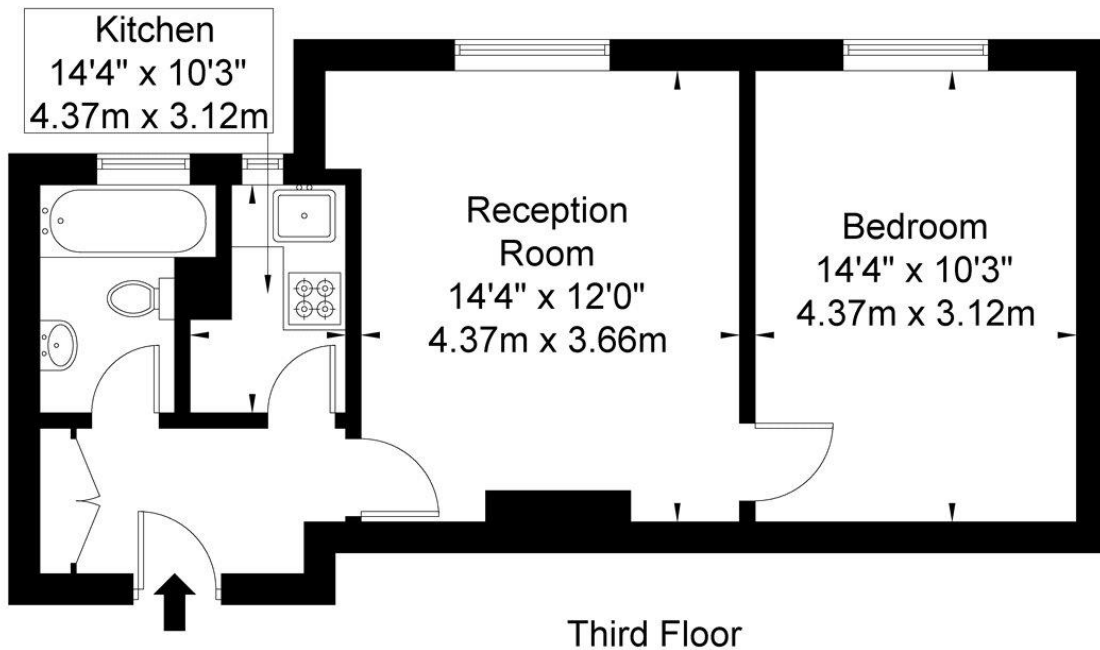
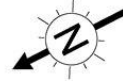

Ref

Copyright **BLEU  
PLAN**

The Floor plan is not to scale and measurements and areas shown are approximate and therefore should be used for illustrative purposes only. The plan has been prepared in accordance with the RICS code of Measuring Practice and whilst we have confidence in the information produced it must not be relied on. If there is any aspect of particular importance, you should carry out or commission your own inspection of the property.

Copyright @ BLEUPLAN

