



## Talbot Road, W2 £3,800 Per Month

A stunning two-bedroom apartment on the second floor, featuring a balcony in the heart of Notting Hill.

Talbot Road is ideally located in the heart of Notting Hill, moments away from a wealth of fashionable eateries, boutique shops, and artisan cafés on Westbourne Grove. Excellent transport links are available at Westbourne Park (Hammersmith & City and Circle lines) and Notting Hill Gate (Central and District lines). The green open spaces of Hyde Park are also within close proximity.

- Two-bedroom apartment
- Second floor with balcony
- Located in Notting Hill
- Close to Hyde Park
- COUNCIL: Westminster (D)
- Deposit: £4,384



020 8450 9377 - 020 8459 1133  
[rentals@cameronsstiff.co.uk](mailto:rentals@cameronsstiff.co.uk)



Talbot Road, W2

Approximate Area = 45.5 sq m / 489 sq ft

For Identification only - Not to Scale

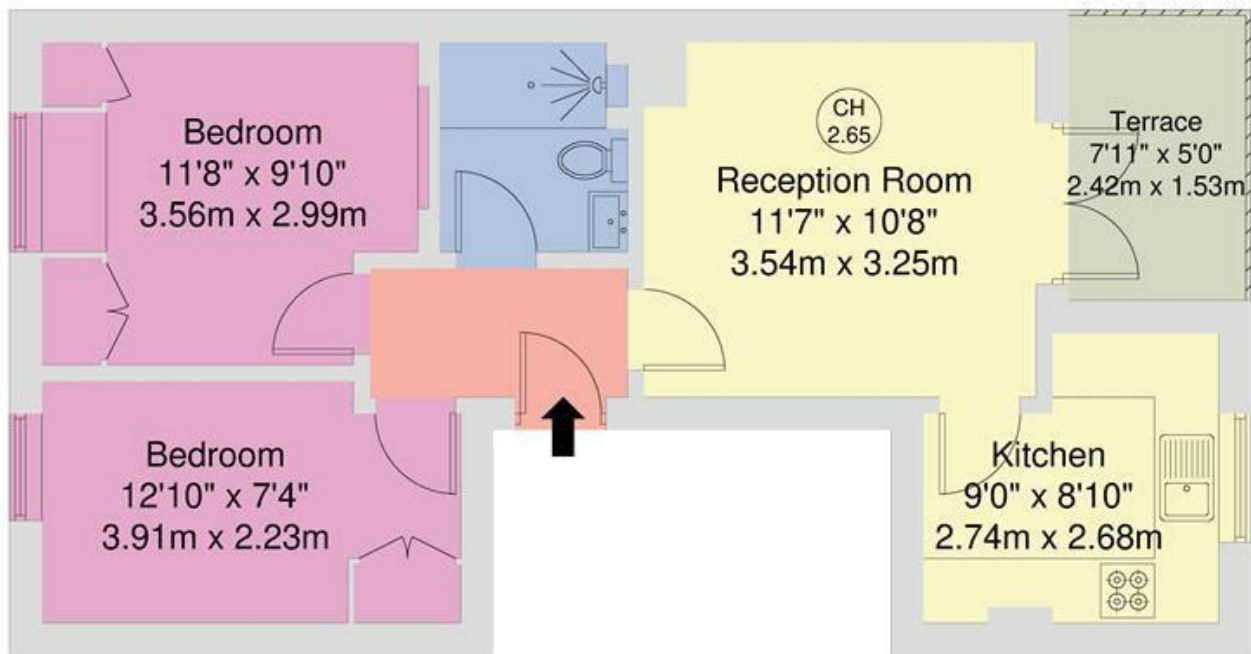

SECOND FLOOR

EPC: C

Ref: 19743585

Disclaimer: Floorplan produced in accordance with RICS guidelines. While we do not doubt the floorplan accuracy and completeness, you or your advisors should conduct a careful, independent investigation of the property in respect of monetary valuation. Produced for Camerons Stiff & Co.

