

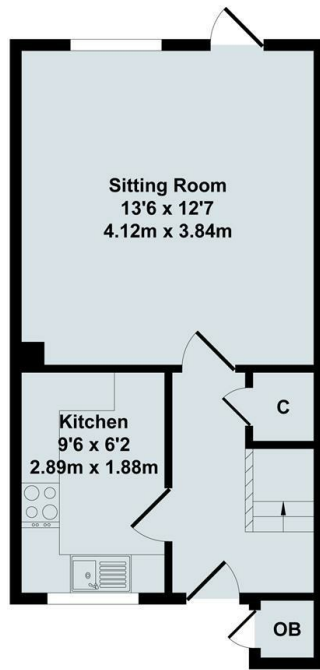

## 38 Gibson Close, Abingdon, Oxfordshire, OX14 1XT

£1,395 Per Month - 15th June 2026.

- Prime location in Abingdon, close to the town centre.
- Well-appointed family bathroom
- The property offers a private garden
- Council Tax: C
- Excellent bus connections to Oxford, Didcot, and surrounding towns.
- Built-in cupboard space and additional storage under the stairs.
- 594 Sq ft
- Spacious sitting room
- Within close proximity to schools, parks, and local shops.
- EPC: D



Ground Floor

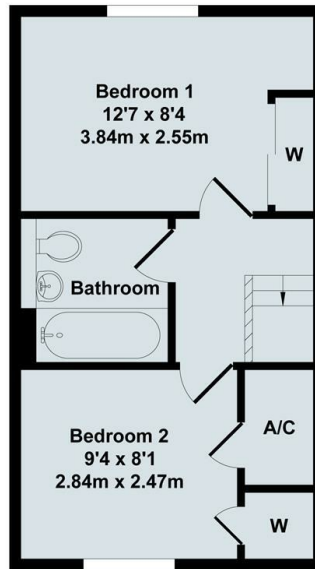

First Floor

Total Approx. Floor Area 594 Sq.Ft. (55.20 Sq.M.)  
 All items illustrated on this plan are included in the "Total Approx Floor Area"

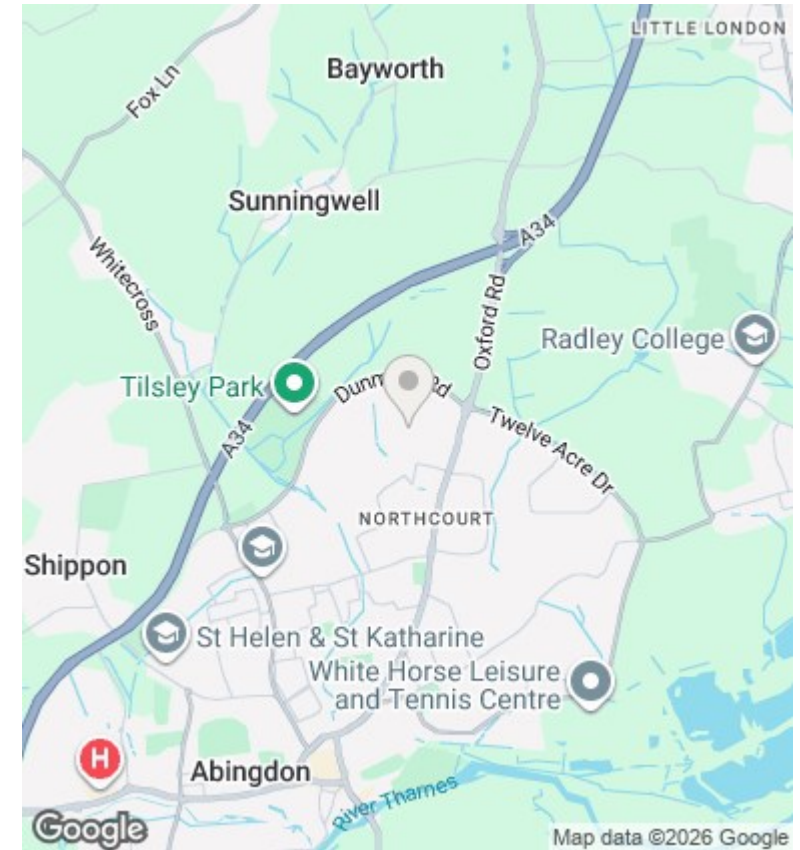

### Directions

### Viewings

Viewings by arrangement only. Call 01235 554950 to make an appointment.

### Council Tax Band

C

### EPC Rating:

D

Energy Efficiency Rating		Current	Potential
<i>Very energy efficient - lower running costs</i>			
(92 plus)	A		
(81-91)	B		89
(69-80)	C		
(55-68)	D	57	
(39-54)	E		
(21-38)	F		
(1-20)	G		
<i>Not energy efficient - higher running costs</i>			
<b>England &amp; Wales</b>		EU Directive 2002/91/EC	