



# TO LET

**Wooldridge Close, Feltham, TW14 8BH**  
**£1,400 Per Calendar Month**

**DBK**  
ESTATE AGENTS

- Available To Rent Beginning of March!
- First Floor Apartment
- Open Plan Kitchen/ Reception Room
- Wraparound Balcony
- Communal Gardens
- Private Gated Development
- One Bedroom
- Family Bathroom Suite
- Allocated Underground Parking
- Heathrow Terminal 4 Station 0.8 miles

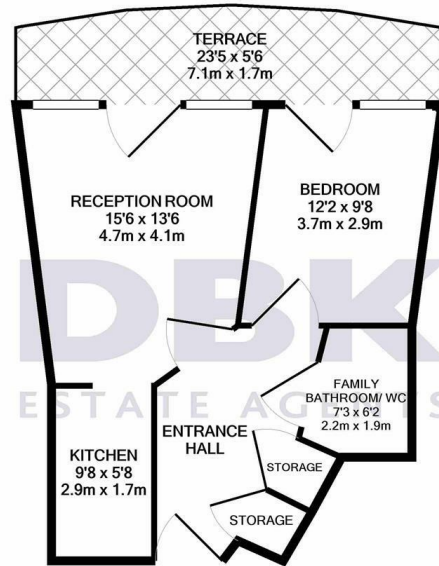

TOTAL APPROX. FLOOR AREA 490 SQ.FT. (45.5 SQ.M.)

Whilst every attempt has been made to ensure the accuracy of the floor plan contained here, measurements of doors, windows, rooms and any other items are approximate and no responsibility is taken for any error, omission, or mis-statement. This plan is for illustrative purposes only and should be used as such by any prospective purchaser. The services, systems and appliances shown have not been tested and no guarantee as to their operability or efficiency can be given  
Made with Metropix ©2021

## THE PROPERTY

Available To Rent Beginning of March! \*Water Bill Included\*

This well-presented one bedroom first floor apartment is set within a private gated development, offering both comfort and security.

The property features a bright open plan kitchen and reception room, designed for modern living and ideal for relaxing or entertaining. The bedroom is well proportioned, complemented by a modern family bathroom suite. A key highlight of the apartment is the wraparound balcony, providing generous outdoor space and an excellent extension of the living area.

Additional benefits include allocated underground parking, access to well maintained communal gardens, and the added convenience of the water bill being included in the rent. Ideally located, Heathrow Terminal 4 Station is approximately 0.8 miles away, making this an excellent option for commuters and frequent travellers alike.