



1-11



Enfields Hythe
Kenny Langer
Hythe Southampton
Hants SO45 3AH
023 805 420
www.hytheenfields.co.uk

7 Dyneley Green,
Guide Price £110,000

🛏️ 2 🚿 1 🚗 1



- Two-bedroom first floor flat
- Separate kitchen
- Study room
- Double glazing
- Quiet residential location close to parks, schools, shops and motorway links
- Spacious and bright living room
- Large windows allowing excellent natural light
- Neutral décor throughout
- Additional external cupboard storage
- Generous main bedroom



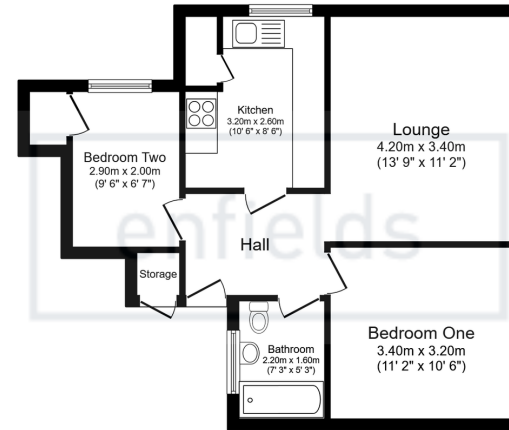

Floor Plan

Total floor area: 49.8 sq.m. (537 sq.ft.)

This floor plan is for illustrative purposes only. It is not drawn to scale. Any measurements, floor areas (including any total floor area), openings and orientations are approximate. No details are guaranteed, they cannot be relied upon for any purpose and do not form any part of any agreement. No liability is taken for any error, omission or misstatement. A party must rely upon its own inspection(s). Powered by www.Propertybox.io



A well-presented two-bedroom first floor flat situated in a quiet residential road in Southampton, offering bright and spacious accommodation throughout. Conveniently located close to parks, local amenities, schools and excellent motorway links.

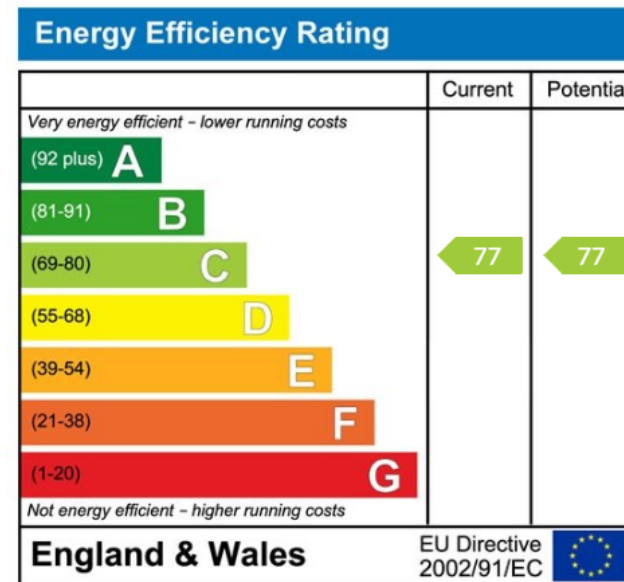

www.enfields-southampton.co.uk



It is Enfields policy to respect any sole agency currently in force and we would not be able to commence marketing until this has expired or been terminated. If you fail to terminate any previous agreement you could be liable for two sets of fees. Enfields Hythe is a trading name of YTF LTD Registered office: 345 Shirley Road, Southampton, Hampshire, England, SO15 3JD. Company Registration No: 10459987. VAT Registration No: 281 2975 81.

Enfields Lettings - Embley Management LTD T/A Enfields. Registered Address: 345 Shirley Road, Southampton, Hampshire, England, SO15 3JD. Company Registration No: 14847604. VAT Registration No: 439 8546 45.