



jordan fishwick

MANCHESTER
Grenfell Road



Grenfell Road, Manchester, M20 6TQ

£925,000



The Property

A well presented, light & spacious, four double bedroom, Victorian semi detached property offering a superb level of family living space over four floors, coupled with a generous garden plot, driveway and an ideal location which is within a short stroll of Didsbury Village. 2241 SQ FT. The accommodation offers a great blend of original characteristics alongside today's more modern comforts, in outline :- Entrance hall with original tiled flooring making way to the lounge with walk-in bay window, separate dining room with an impressive fireplace, in turn opening to the bespoke kitchen extending over 25ft with a comprehensive range of units and large sliding doors opening to the garden. Two double bedrooms and luxury four piece suite bathroom with separate bath and shower with under floor heating are on the first floor, with a further two double bedrooms and separate shower room at second floor level. In addition, there is an excellent basement with utility area, additional shower & WC and a further large chamber currently used for storage but could also be converted.

Directions

M20 6TQ



- Attractive Victorian semi detached
- Stylish living space over four floors
- Four double bedrooms
- Three bathrooms
- Living room with walk-in bay window
- Bespoke dining kitchen over 25ft
- Excellent basement
- Generous garden plot
- Driveway
- Great location close to Didsbury Village

Postcode - M20 6TQ

EPC Rating - E

Floor Area - 2241.00 sq ft

Local Authority - Manchester City Council

Council Tax - E



LOWER GROUND FLOOR
494 sq.ft. (45.9 sq.m.) approx.

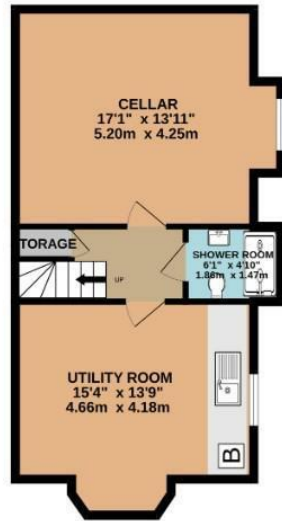

GROUND FLOOR
762 sq.ft. (70.8 sq.m.) approx.

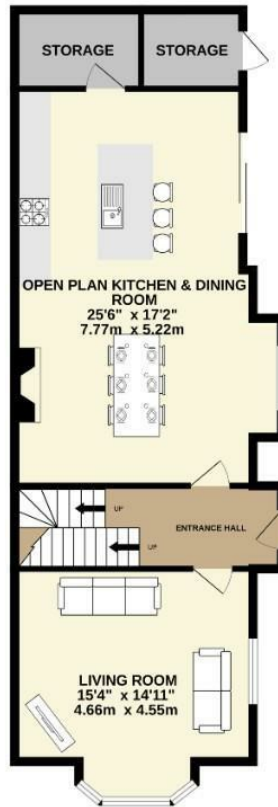

FIRST FLOOR
470 sq.ft. (43.6 sq.m.) approx.



SECOND FLOOR
516 sq.ft. (48.0 sq.m.) approx.

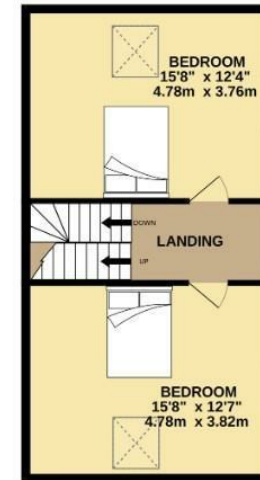

TOTAL FLOOR AREA : 2241 sq.ft. (208.2 sq.m.) approx.
Measurements are approximate. Not to scale. Illustrative purposes only
Made with Metropix ©2026



These particulars are believed to be accurate but they are not guaranteed and do not form a contract. Neither Jordan Fishwick nor the vendor or lessor accept any responsibility in respect of these particulars, which are not intended to be statements or representations of fact and any intending purchaser or lessee must satisfy himself by inspection or otherwise as to the correctness of each of the statements contained in these particulars. Any floorplans on this brochure are for illustrative purposes only and are not necessarily to scale.

Offices also at: Wilmslow, Macclesfield, Hale, Sale, Chorlton, Glossop, Manchester & Salford

757-759 Wilmslow Road, Didsbury Village, Manchester

0161 445 4480

didsbury@jordanfishwick.co.uk
www.jordanfishwick.co.uk