

3 Robin Close - £900 PCM

Mildenhall Bury St. Edmunds IP28 7HJ

shires

Estate & Letting Agents



"Consistently providing outstanding service to our clients"

£900 PCM

The Property

This one bedroom apartment is situated on a popular residential estate close to the town centre.

There is an open plan lounge/kitchen with a fitted bathroom and first floor bedroom.

An ideal home to suit a single tenant or couples alike.

Off road parking is offered to ensure security.

Call now to view!

Features

- DOUBLE BEDROOM
- OPEN PLAN
- MODERN KITCHEN/DINER
- AIR-CONDITIONING
- GARDEN
- EASY COMMUTE TO RAF BASES
- CLOSE TO TOWN CENTRE
- COUNCIL TAX BAND - A
- EPC RATING - D
- CALL SHIRES NOW TO VIEW!



These sales particulars have been produced as a general guide only and we would draw to your attention that we have not carried out a detailed Survey of the property nor have we tested services, appliances or specific fittings. Whilst measurements and statements given within the details are provided in good faith, their accuracy should not be relied upon. If there are any points about which you may be uncertain or would like further clarification, we would suggest that you telephone this office and speak to our staff who will endeavour to assist you.

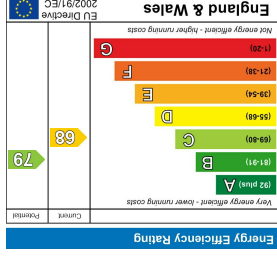

4 New Street, Mildenhall, Suffolk, IP28 7EN
 T: 01638 712132
 E: mildenhall@shiresestateagents.co.uk

Whilst every attempt has been made to ensure the accuracy of the floorplan contained here, measurements of doors, windows, rooms and any other items are approximate and no responsibility is taken for any error, omission or mis-statement. This plan is for illustrative purposes only and should be used as such by any prospective purchaser. The services, systems and appliances shown have not been tested and no guarantee as to their operability or efficiency can be given.
 Made with Metropix ©2025

TOTAL FLOOR AREA: 33.4 sq.m. (359 sq.ft.) approx.

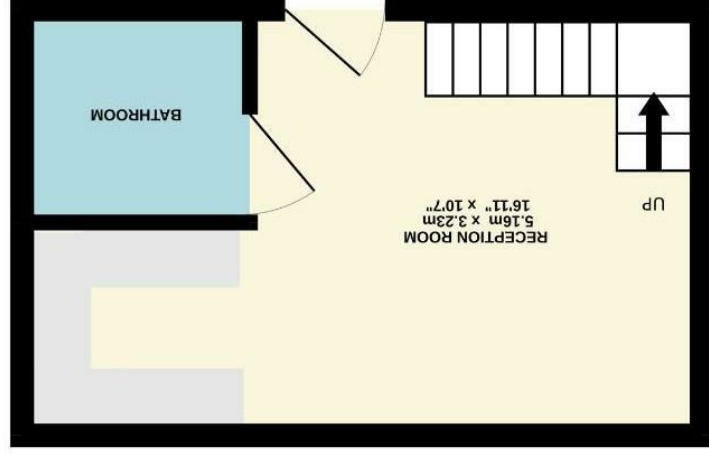

GROUND FLOOR
16.7 sq.m. (180 sq.ft.) approx.

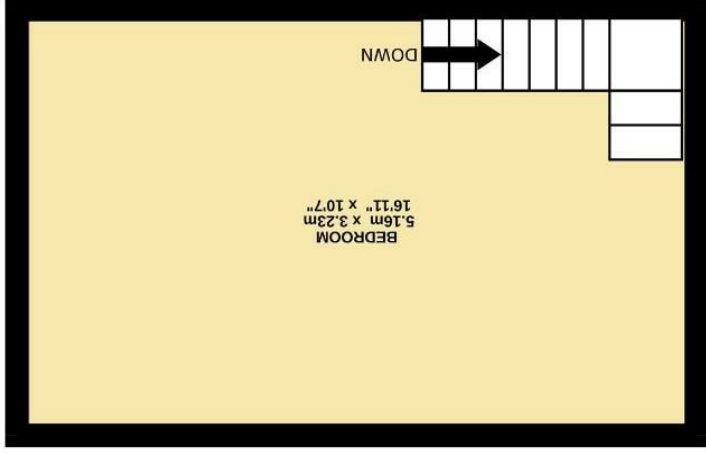

1ST FLOOR
16.7 sq.m. (180 sq.ft.) approx.