



**OFFICE HOURS:**

Monday to Friday	9 am	to	5 pm
Saturday	9 am	to	2 pm
Sunday and Bank Holidays	12 noon	to	2 pm

## 10 good reasons to choose DMA

- \* Open 7 days a week.
- \* Filey's longest established family run independent estate agency.
- \* Prompt efficient friendly service.
- \* 360° virtual tours and floor plans.
- \* Free advertising: no sale - no charge.
- \* Free no obligation market valuation.
- \* Free accompanied viewing.
- \* Dedicated sales progression.
- \* Prominent town centre location.
- \* Modern walk-round self selection display.

RESIDENTIAL SALES

**DMA** ESTATE AGENTS

COMMERCIAL SALES

Proprietors: David Mansfield ATTON FNAEA.  
Samantha ADDISON  
[www.dmaestateagents.co.uk](http://www.dmaestateagents.co.uk)  
ESTABLISHED 1992



These particulars are intended only to give a fair description of the property, as a guide to prospective buyers. Accordingly a) their accuracy is not guaranteed and neither DMA Estate Agents nor the vendor(s) accept any liability in respect of their contents; b) they do not constitute an offer or contract of sale, and c) any prospective purchaser should satisfy themselves by inspection or otherwise as to the correctness of any statement or information in these particulars.

# DMA

ESTATE AGENTS



67 SCARBOROUGH ROAD, FILEY YO14 9NQ



Freehold £238,000

### FEATURES

- \* Ideal family home.
- \* Three / four bedroom mid terrace house.
- \* Located close to the town centre and convenient for most amenities.
- \* Gas central heating to radiators.
- \* Upvc double glazing.
- \* Modern kitchen and bathroom.
- \* Recently converted loft incorporating ensuite shower room.
- \* Gardens front and rear.
- \* Parking to the front.
- \* **EPC Rating: C.**
- \* Viewing is highly recommended.

### ACCOMMODATION IN BRIEF

GROUND FLOOR:	Front Door to Entrance Porch. Hall. Lounge. Dining Kitchen. Utility Room.
FIRST FLOOR:	Two Bedrooms. Bathroom. Bedroom / Study
Stairs from Bedroom to:	
SECOND FLOOR:	Further bedroom. Ensuite Shower Room.
OUTSIDE:	Parking to the front. Enclosed rear garden.

26 Belle Vue Street, FILEY, North Yorks. YO14 9HY. Telephone: 01723 515527  
[www.dmaestateagents.co.uk](http://www.dmaestateagents.co.uk) / [www.rightmove.co.uk](http://www.rightmove.co.uk)





67 SCARBOROUGH ROAD, FILEY

**Upvc Front Doors to:**

**ENTRANCE PORCH**

Upvc double glazed windows.



**Upvc Double Glazed Door to:**

**ENTRANCE HALL**

Radiator.



**LOUNGE**  
**4.87m x 4.44m (16'0" x 14'7")**

'Living flame' gas fire. Radiator.  
Three upvc double glazed window.

*/ continued over*



### DINING KITCHEN

3.50m x 3.53m (11'6" x 11'7")

Inset white sink, vegetable sink and drainer. Modern base units with worktops over. Matching wall cupboards. Gas hob. Built-in oven. Integrated 'fridge / freezer and dishwasher. Laminate flooring. Gas combination boiler. Inset spotlights. Radiator. Upvc double glazed window.



### UTILITY ROOM

Base cupboards with worktops over. Tall larder cupboard. Understairs cupboard. Plumbing for automatic washing machine and tumble dryer. Laminate flooring. Radiator. Upvc double glazed window. **Upvc double glazed door.**



**Floor Plan:**

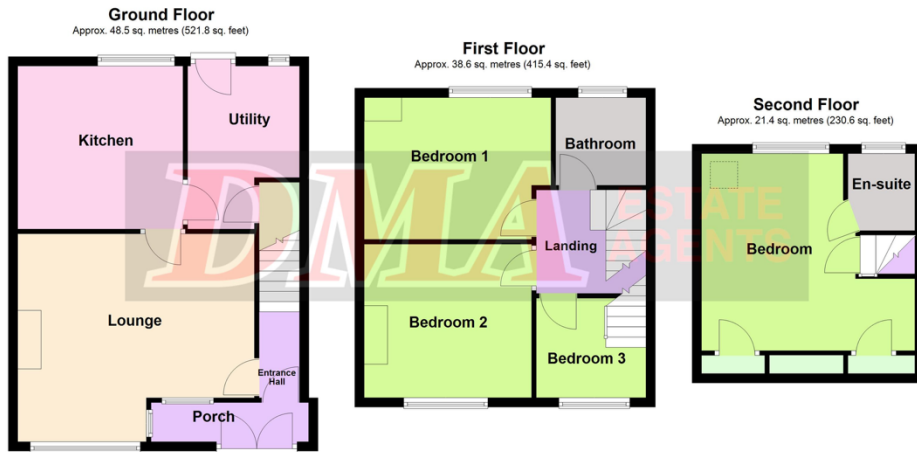

Total area: approx. 108.5 sq. metres (1167.9 sq. feet)

Please note this floor plan is only a guide and not to scale.  
Plan produced using PlanUp.

67 Scarborough Road, Filey

**FIRST FLOOR:**

**BATHROOM**  
1.93m x 1.87m (6'4" x 6'2")

'P' shaped bath with electric shower over and screen. Handbasin in vanity unit and wc. Tiled walls. Chrome ladder radiator. Upvc double glazed window.



**BEDROOM ONE** 3.53m x 3.47m (11'7" x 11'5")

Feature fireplace. Radiator. Upvc double glazed window.



**BEDROOM TWO** 4.06m x 3.20m (13'0" x 10'6")

Original 'cast iron' fireplace. Radiator. Upvc double glazed window.



/ continued over

**BEDROOM THREE**  
3.12m x 2.33m (10'3" x 7'8")

Radiator. Upvc double glazed window.



**ENSUITE**

Corner shower cubicle with electric shower. Handbasin and wc. Chrome ladder. Inset spotlights. Radiator. Upvc double glazed window.



**Stairs to:**

**BEDROOM**  
4.57m x 4.21m (15'0" x 13'10")

Inset spotlights. Radiator. 'Velux' window. Upvc double glazed window.



**OUTSIDE:**

Parking to the front. Enclosed rear garden laid to patio and decking. Large **SHED 4.87m x 2.43m (16'0" x 8'0") with light and power.**



**Council Tax Band A.**

**DIRECTIONS:**

From the DMA office follow the Scarborough road out of Filey and the property is located on the left hand side.

**Viewing strictly by appointment only through DMA Estate Agents**