



Marigold Road, Stratford-upon-avon, CV37 7DW

Stratford-upon-Avon

£100,000



Property Type: Coach House

Bedrooms: 2

Bathrooms: 1

Receptions: 1

This well-presented coach house is available at 40% shared ownership, with the option to staircase up to 100%. This spacious property offers approximately 853 sq ft of total accommodation, including two bedrooms, a generous light and airy open-plan living, dining and kitchen area, bathroom and garage. Additional benefits include parking with an EV charge point, along with a popular location within walking distance of Stratford town centre, giving easy access to shops, amenities and transport links. A fantastic option for buyers looking to step onto the property ladder with the flexibility to increase ownership in the future.

- 40% Shared Ownership
- Spacious and Well Presented
- Two Bedrooms
- Garage
- EV Charge Point
- Driveway
- Open Plan Living
- Recently Refitted Bathroom
- Walking Distance Of Town Centre
- Quote Reference Code: GG0894





GROUND FLOOR
185 sq. ft. (17.2 sq.m.) approx.

FIRST FLOOR
668 sq. ft. (62.1 sq.m.) approx.

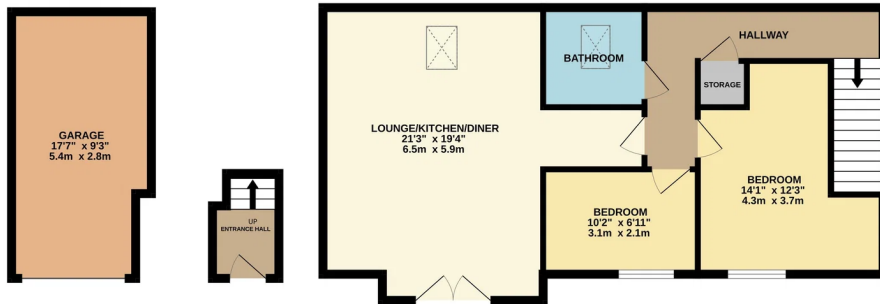

TOTAL FLOOR AREA : 853 sq. ft. (79.3 sq.m.) approx.

Whilst every attempt has been made to ensure the accuracy of the floorplan contained here, measurements of doors, windows, rooms and any other items are approximate and no responsibility is taken for any error, omission or mis-statement. This plan is for illustrative purposes only and should be used as such by any prospective purchaser. The services, systems and appliances shown have not been tested and no guarantee as to their operability or efficiency can be given.
Made with Metrepx ©2020

Energy Efficiency Rating		
	Current	Potential
Very energy efficient - lower running costs		
(92 plus) A		
(81-91) B		
(69-80) C	78	78
(55-68) D		
(39-54) E		
(21-38) F		
(1-20) G		
Not energy efficient - higher running costs		
England & Wales	EU Directive 2002/91/EC	



Giles Guest EXP

07754 095 497

giles.guest@expuk.com

<https://gilesguest.exp.uk/>