



Christchurch Hill

Hampstead Village, NW3

Asking Price £500,000

A lovely one bedroom flat situated on the ground floor comprising 20'6 x 12'6 reception room with a contemporary open plan kitchen with a granite work surface, 16'7 x 9'10 double bedroom and a modern shower room.

Christchurch Hill is an historic address perfectly positioned betwixt Hampstead Village and the open acres of Hampstead Heath. Hampstead Underground (Northern Line) is located just 0.3 miles away.

Sole agent.



Christchurch Hill

Hampstead Village, NW3

- One double bedroom flat
- Wood floors
- Long lease
- Hampstead Village location
- 0.2 miles to Hampstead Heath
- 0.3 Miles to Hampstead Underground



Tenure: Leasehold 114 years remaining.
Service Charge: £2,148 per annum.
Ground Rent: £10 per annum.
Local Authority: Camden
Council Tax Band: F

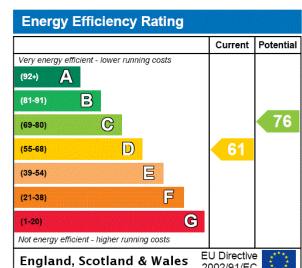

Chestertons Hampstead Sales

55-56 Hampstead High Street
 Hampstead
 NW3 1QH
 hampstead@chestertons.co.uk
 020 7794 3311
 chestertons.co.uk

Christchurch Hill,
Hampstead Village, NW3

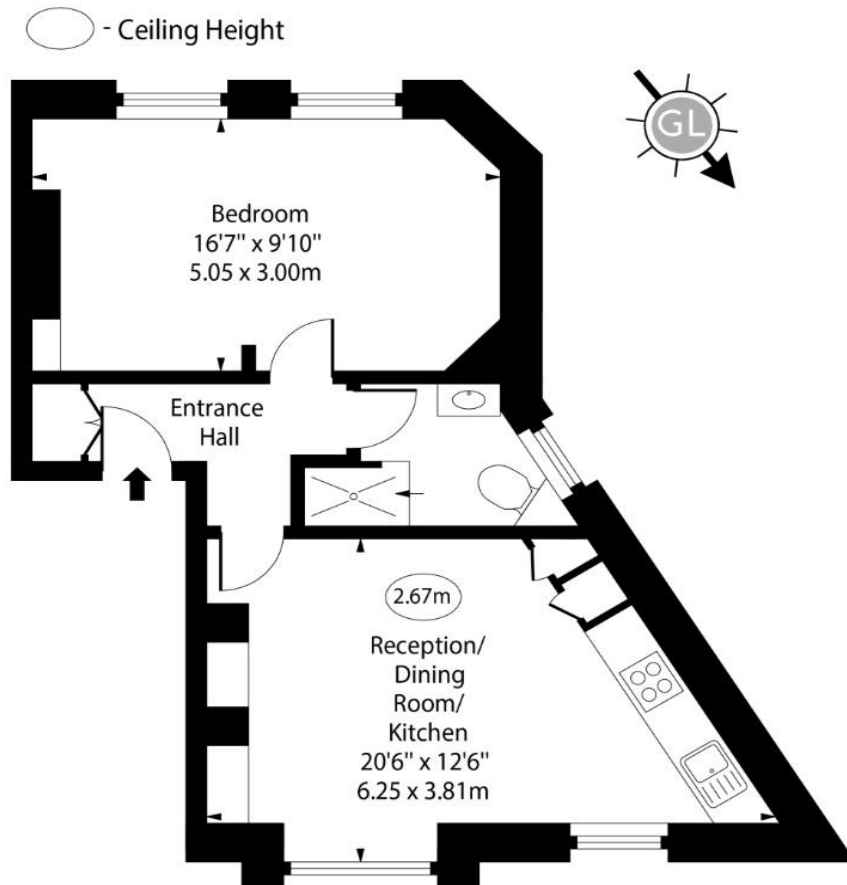

Ground Floor

Approx Gross Internal Area 453 Sq Ft - 42.08 Sq M

For Illustration Purposes Only - Not To Scale

www.goldlens.co.uk

Prepared for Chestertons

Ref. No. 024063K

