



12 Broomfield Place, Newport.

Offers in the region of **£190,000**

Being excellently proportioned, this two Bedroom mid-terrace house is just a stone's throw from Newport town centre and offers such perks as a recently installed gas combi-boiler and separate Garage. With a 16ft Lounge/Diner, an enclosed West-facing garden and two double Bedrooms, it is the perfect first time purchase, downsize option or investment opportunity!

Briefly comprising Lounge/Diner, Kitchen 2 Bedrooms and a modern Bathroom (with a shower over the bath), externally there are gardens to the front and rear, a useful Garage and on-street parking. Benefiting from gas C.H. and uPVC windows and doors, it is located within a quiet cul-de-sac. Council tax band B. EPC Rating C.

12 Broomfield Place Newport Shropshire

Property entered via newly fitted composite door into

Lounge/Diner 16' 2" x 14' 11" (4.92m x 4.54m) (max)
Stairs to the first floor.

Kitchen 14' 10" x 6' 11" (4.52m x 2.11m)
Newly fitted part-glazed uPVC door to the rear garden.

Upstairs to first floor landing which provides access to both Bedrooms and Bathroom. Door to useful storage cupboard. Loft hatch with fitted ladder.

Bedroom 1 14' 11" x 10' 11" (4.54m x 3.32m) (max)
Built-in double wardrobes.

Bedroom 2 10' 3" x 8' 3" (3.12m x 2.51m)

Bathroom 6' 11" x 6' 5" (2.11m x 1.95m)

Externally

The property is approached off a paved pathway with front garden mainly laid to lawn.

To the rear can be found a generous, west facing garden which is mainly laid to lawn with two patio areas and edged by fencing on all sides. There is also an access gate to the rear leading onto the lane which runs past the recreational area. Outside water tap and electric light.

Single Garage 15' 8" x 8' 4" (4.77m x 2.54m)
Single Garage with up-and-over door located within a block of garages opposite the property.

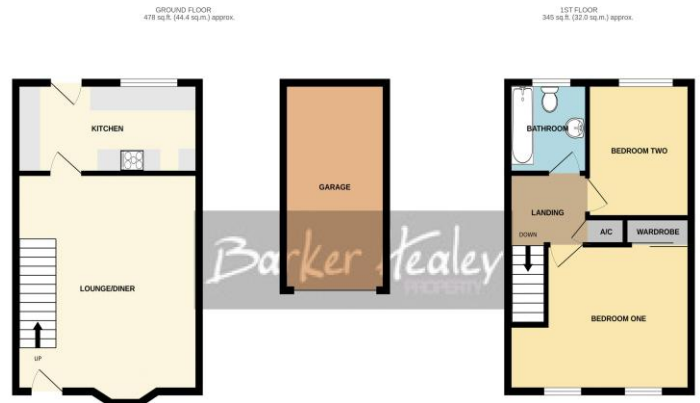

TOTAL FLOOR AREA: 823 sq ft (76.4 sq m) approx.
While every attempt has been made to ensure the accuracy of the floorplan contained herein, measurements of floors, windows, walls and any other items are approximate and no responsibility is taken for any error, omission or mis-statement. The plan is for illustrative purposes only and should be used as such by any prospective purchaser. The services, systems and appliances shown have not been tested and no guarantee as to their operability or efficiency can be given. Made with Ameygo 12/2020.

10 High Street, Newport,
Shropshire, TF10 7AN
Tel: 01952 813625
Email: info@barkerhealey.co.uk
Web: www.barkerhealey.co.uk
VIEWING STRICTLY BY APPOINTMENT ONLY

Barker Healey

PROPERTY



Printed by Ravensworth 01670 713330



MONEY LAUNDERING REGULATIONS 2003 Intending purchasers will be asked to produce identification and proof of financial status when an offer is received. We would ask for your co operation in order that there will be no delay in agreeing the sale.
THE PROPERTY MISDESCRIPTIONS ACT 1991 The Agent has not tested any apparatus, equipment, fixtures and fittings or services and so cannot verify that they are in working order or fit for the purpose. A Buyer is advised to obtain verification from their Solicitor or Surveyor. References to the Tenure of a Property are based on information supplied by the Seller. The Agent has not had sight of the title documents. A Buyer is advised to obtain verification from their Solicitor. You are advised to check the availability of this property before travelling any distance to view. We have taken every precaution to ensure that these details are accurate and not misleading. If there is any point which is of particular importance to you, please contact us and we will provide any information you require. This is advisable, particularly if you intend to travel some distance to view the property. The mention of any appliances and services within these details does not imply that they are in full and efficient working order. These particulars are in draft form awaiting Vendors confirmation of their accuracy. These details must therefore be taken as a guide only and approved details should be requested from the agents.