



Castles

£465,000

Linden Gardens

Enfield, EN1 4DX Freehold

## PROPERTY SUMMARY

Three end-terrace house presents a fantastic opportunity for those looking to create their dream home or for investors seeking a project. Built in 1930, the property boasts a generous 775 square feet of living space, featuring two reception rooms and three well-proportioned bedrooms, making it ideal for families or those needing extra space.

The house is in need of significant renovation, offering a blank canvas for buyers to unleash their creativity and personal touch. The property also includes a spacious garden, perfect for outdoor activities or gardening enthusiasts, along with a double garage at the end of the garden, providing ample storage or potential for further development.

This property is an excellent choice for residential buyers looking to invest time and effort into a home that can be tailored to their needs. Alternatively, it presents a promising opportunity for investors seeking to enhance their portfolio.





Linden Gardens, Enfield, EN1

Approximate Gross Internal Area = 1122 sq ft / 104.2 sq m

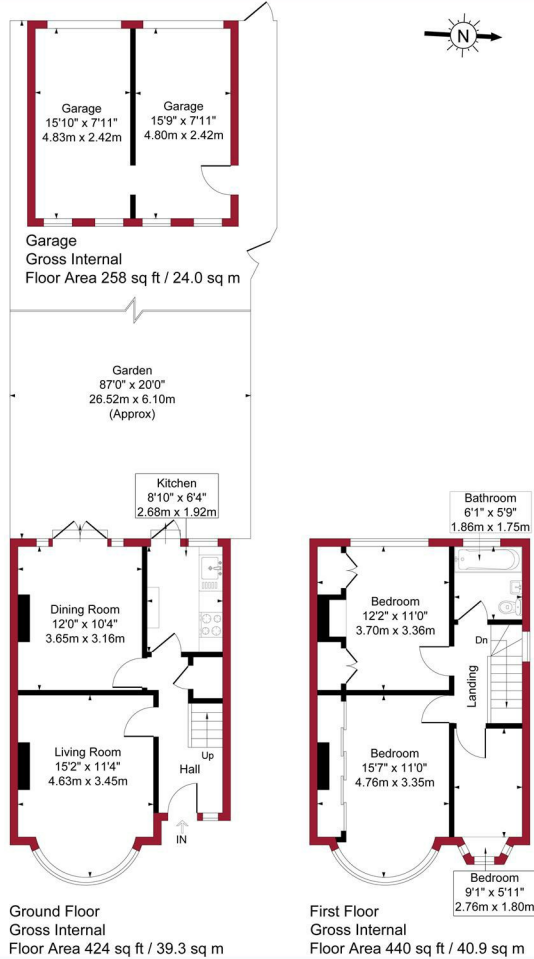

For a guide to the area please scan this code for more information

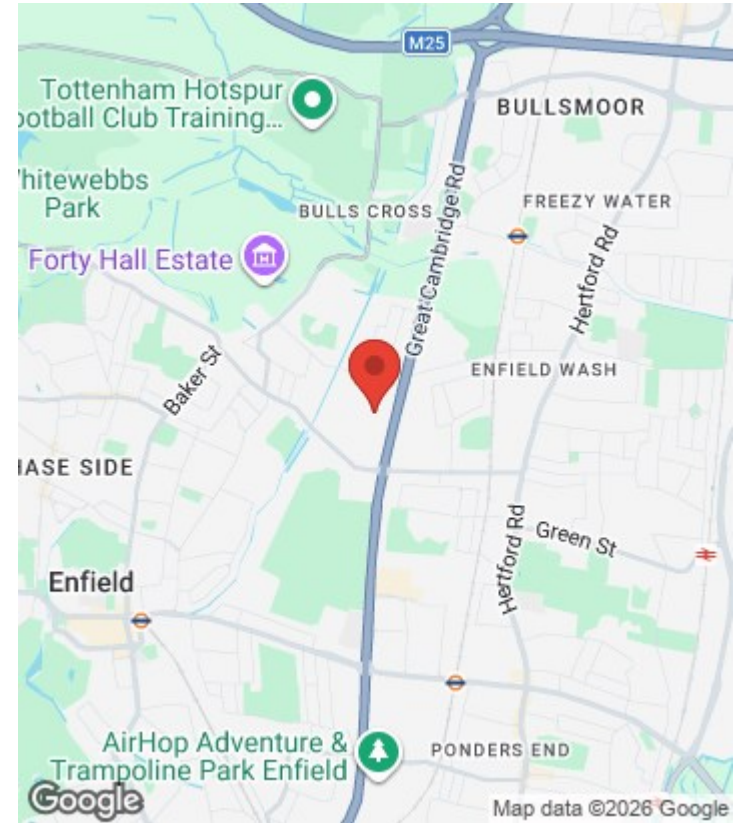
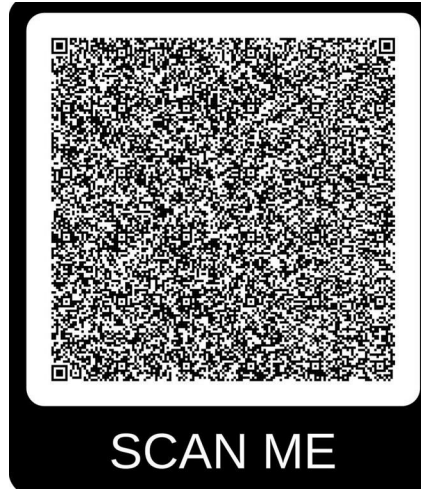

House - End Terrace

Freehold

**Council:** Enfield

**Council Tax Band:** D

Agents Note: Whilst every care has been taken to prepare these particulars, they are for guidance purposes only. All measurements are approximate and are for general guidance purposes only and whilst every care has been taken to ensure their accuracy, they should not be relied upon and potential buyers/tenants are advised to recheck the measurements



**OFFICE ADDRESS**

243 - 245 Hertford Road  
Enfield  
London  
EN3 5JJ

**OFFICE DETAILS**

0208 804 8000  
enfield@castles.london  
<https://www.castles.london>

