



Gilmerton Court | Trumpington | Cambridge | CB2 9HQ

£1,750 PCM

COOKE
CURTIS
& CO

Key features

- 87 sqm / 940 sqft
- 3 bed / 1 bath / 1 recep
- EPC - D
- Council tax band - D
- Gas central heating
- Available now
- Communal gardens
- Secure bike store

Description

A beautifully presented three bedroom flat, conveniently located for access to Addenbrooke's Hospital, the city centre and the M11, set in landscaped communal gardens.



Directions

Gilmerton Court stands at the corner of Long Road and Trumpington Road within half a mile of Trumpington's excellent facilities and with easy access into the City, Addenbrooke's and all major road links. Trumpington is a thriving, fast growing part of the city that still manages to retain its village identity and sense of community. It is exceptionally well located for access into the Addenbrooke's campus, out to the M11 and into the city by car, bus, guided bus or one of a few purpose-built cycle routes. The city's mainline station can be easily reached along the guided highway cycleway without having to mix





Floor plans

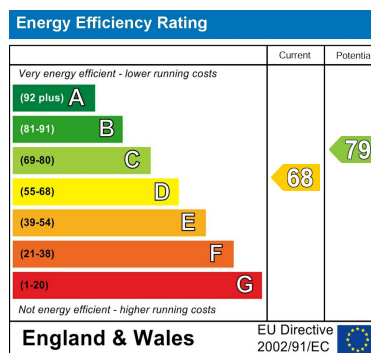
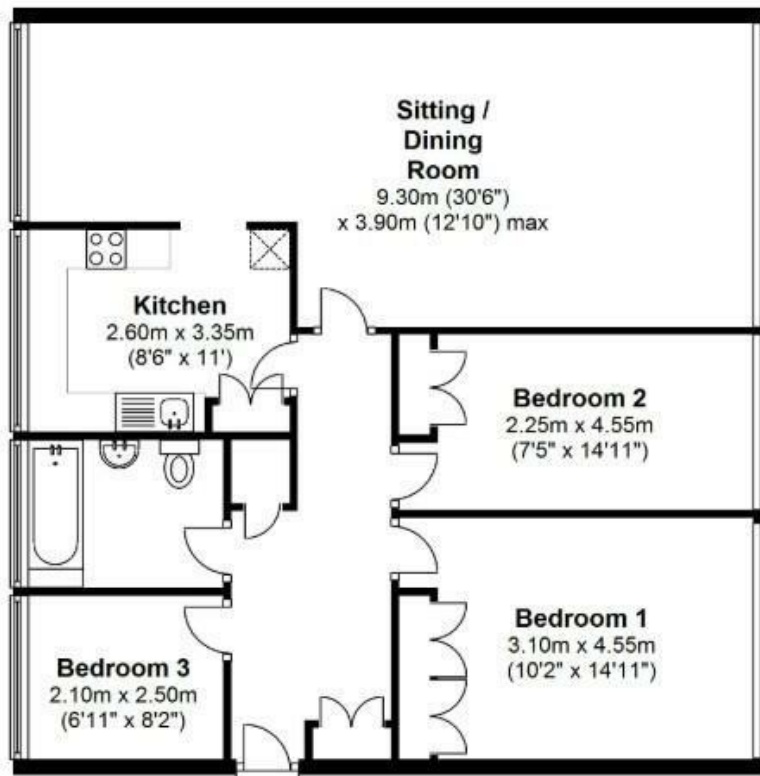

Council Tax Band **D** EPC Rating **D**

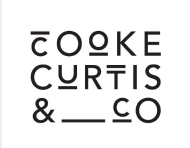

40 High Street
Trumpington
Cambridge
Cambridgeshire
CB2 9LS
01223 508050

hello@cookecurtis.co.uk
cookecurtis.co.uk