



Felmersham Close

London, SW4

£2,000 per month

An incredibly spacious one bedroom first floor flat ideally situated close to Clapham Common. The property benefits from wooden floors throughout and comprises a large reception room, separate fully fitted kitchen and modern bathroom.

CHESTERTONS

Felmersham Close, SW4

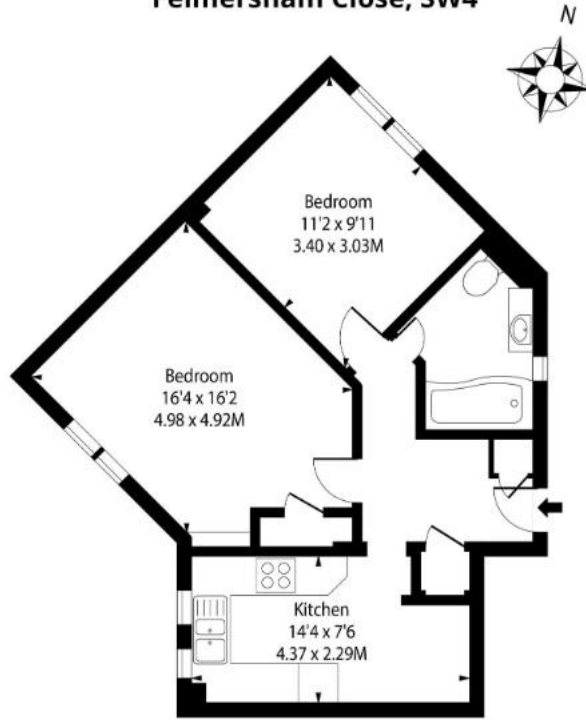

First Floor

Approx Gross Internal Area **524 Sq Ft - 48.69 Sq M**

For Illustration Purposes Only - Not to Scale

Ref: No. 50110

Minimum Term: 12 months
Deposit Required: £2,307.69
Local Authority: Lambeth
Council Tax Band: B
EPC Rating: D
Furnished

Energy Efficiency Rating		Current	Potential
Very energy efficient - lower running costs			
(92+)	A		
(81-91)	B		
(69-80)	C		
(55-68)	D	68	80
(39-54)	E		
(21-38)	F		
(1-20)	G		
Not energy efficient - higher running costs			
England, Scotland & Wales		EU Directive 2002/91/EC	

Chestertons Clapham Common Lettings

chestertons.co.uk

Additional tenant charges apply (fees apply to non-AST tenancies only)

Tenancy Agreement Fee: £300

References per Tenant/Guarantor: £60

Inventory check (approx. £100 – £250 inc. VAT)

chestertons.co.uk/property-to-rent/applicable-fees

