



## Ossulton Way | London | N2

£2,000 Per month |

 2  1  1  D

**ADN**  
RESIDENTIAL

A well presented two double bedroom apartment arranged over the ground floor of a well maintained purpose built block located in East Finchley. The property benefits from having wooden flooring and comprises; reception room with bay window, fully fitted separate kitchen, two double bedrooms, family bathroom and a guest W/C. Additional benefits include access to lovely communal gardens.

- Two Double Bedrooms
- Kitchen
- Guest W/C
- Permit Parking
- Reception Room
- Family Bathroom
- Communal Gardens

Council Tax Band: D  
EPC: D





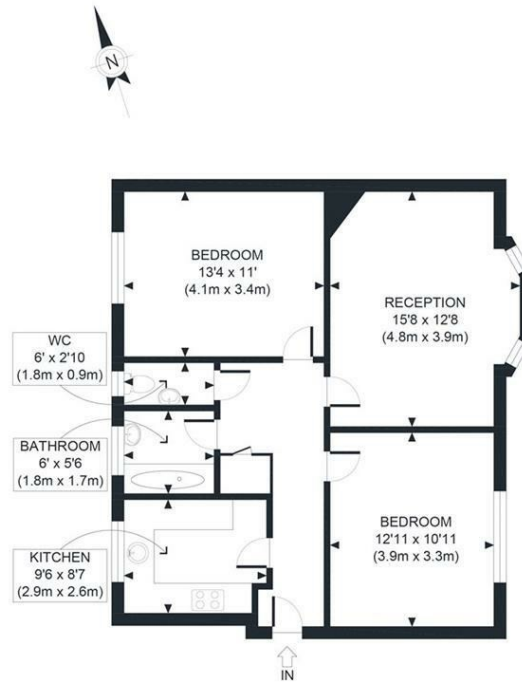

GROUND FLOOR  
GROSS INTERNAL  
FLOOR AREA 719 SQ FT

APPROX. GROSS INTERNAL FLOOR AREA 719 SQ FT / 67 SQM

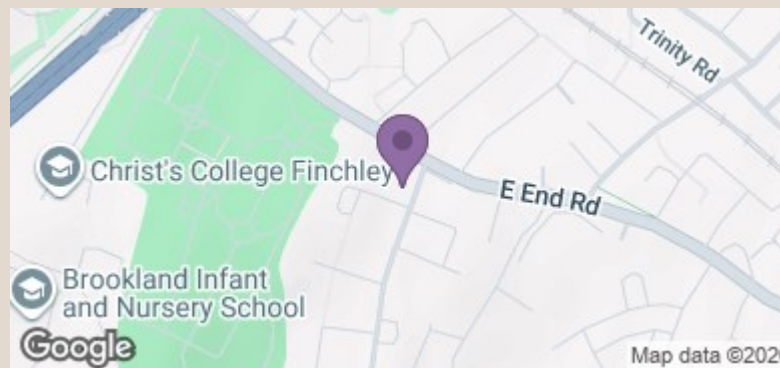

Energy Efficiency Rating		Current	Potential
Very energy efficient - lower running costs			
(92 plus) <b>A</b>			
(81-91) <b>B</b>			
(69-80) <b>C</b>			
(55-68) <b>D</b>		68	78
(39-54) <b>E</b>			
(21-38) <b>F</b>			
(1-20) <b>G</b>			
Not energy efficient - higher running costs			
<b>England &amp; Wales</b>		EU Directive 2002/91/EC	