

68 Coventry Street

Brighton, BN1 5PQ

Offers in excess of £635,000

There is something undeniably special about Victorian homes, and this handsome three-bedroom terraced house on Coventry Street is no exception. Combining generous proportions, original character and exciting potential, it offers a wonderful opportunity to create a forever home in the heart of the ever-popular Port Hall district.

The Port Hall district is renowned for its friendly community atmosphere and enviable convenience. Seven Dials is just moments away, offering an excellent selection of independent cafés, artisan bakeries, pubs and restaurants, while Brighton Station, excellent local schools, Dyke Road Park and St Ann's Well Gardens are all within easy walking distance.

Inside, the accommodation is both spacious and versatile, with three genuine double bedrooms, a generous living room, a well-appointed kitchen, family bathroom and the added practicality of a separate WC. Beautiful period features, including decorative cornicing and Victorian fireplaces, provide a charming reminder of the property's heritage, while the well-balanced layout offers plenty of scope for sympathetic updating to suit modern lifestyles.

Outside, the house immediately impresses with its attractive Victorian façade and traditional tiled pathway leading to the front door. To the rear, the enclosed walled courtyard garden is attractively planted and offers a peaceful space to relax or entertain, while the front garden further enhances the property's kerb appeal.

Offering timeless character, generous family accommodation and the opportunity to make it your own, this is a home that will appeal to those looking to enjoy everything this vibrant part of Brighton has to offer.



Coventry Street

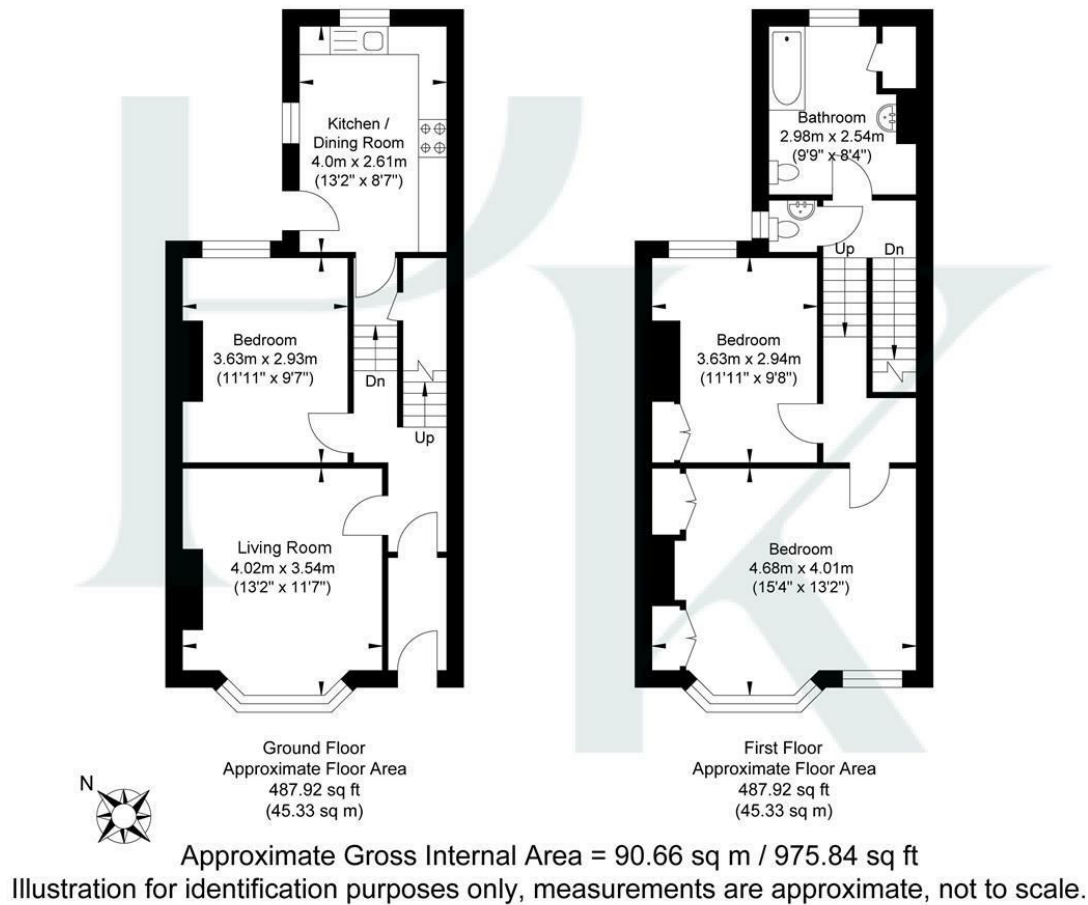

Energy Efficiency Rating	
Current	Potential
	89
66	

Very energy efficient - lower running costs

Very energy efficient - lower running costs

Not energy efficient - higher running costs

England & Wales EU Directive 2002/91/EC

Environmental Impact (CO ₂) Rating	
Current	Potential

Very environmentally friendly - lower CO₂ emissions

Very environmentally friendly - lower CO₂ emissions

Not environmentally friendly - higher CO₂ emissions

England & Wales EU Directive 2002/91/EC

Pearson
Keehan