



# Thurlow Road

Hampstead, NW3

£3,750 per month  
(£865.38 per week)

A beautiful duplex 2 double bedroom apartment set on the top (2nd/3rd) floors of this beautiful semi-detached period house. The property is situated in one of Hampstead's premier tree lined roads in Hampstead Village. Accommodation comprises spacious reception room, semi open plan fully fitted kitchen, 2 double bedrooms, bathroom, shower room.

**CHESTERTONS**



# Thurlow Road

## Hampstead, NW3

- Top Floor Duplex Apartment in Period Building
- 2 Bedrooms, 2 Bathrooms, Reception Kitchen
- Situated in Premier Road in Heart of Hampstead Village



**Minimum Term:** 12 months  
**Deposit Required:** £4,326.92  
**Local Authority:** London Borough Of Camden  
**Council Tax Band:** F  
**EPC Rating:** D  
**Unfurnished**

Energy Efficiency Rating		Current	Potential
Very energy efficient - lower running costs			
(92-100)	A		
(81-91)	B		
(69-80)	C		
(55-68)	D	65	65
(39-54)	E		
(21-38)	F		
(1-20)	G		
Not energy efficient - higher running costs			
England, Scotland & Wales		EU Directive 2002/91/EC	

### *Chestertons Hampstead Lettings*

55-56 Hampstead High Street  
 Hampstead  
 London  
 NW3 1QH  
[hampsteadlettingsusers@chestertons.co.uk](mailto:hampsteadlettingsusers@chestertons.co.uk)  
 02077941125  
[chestertons.co.uk](http://chestertons.co.uk)

Additional tenant charges apply (fees apply to non-AST tenancies only)  
 Tenancy Agreement Fee: £300  
 References per Tenant/Guarantor: £60  
 Inventory check (approx. £100 – £250 inc. VAT)  
[chestertons.co.uk/property-to-rent/applicable-fees](http://chestertons.co.uk/property-to-rent/applicable-fees)

Thurlow Road,  
Hampstead, NW3

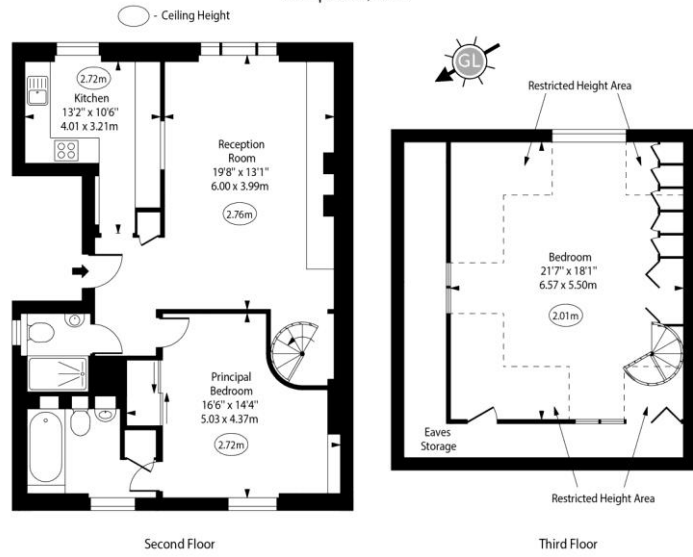

Approx Gross Internal Area	988 Sq Ft - 91.79 Sq M
Approx. Floor Area Including Restricted Heights (Including Eaves Storage)	1275 Sq Ft - 118.45 Sq M

For Illustration Purposes Only - Not To Scale  
www.goldlens.co.uk  
Prepared for Chestertons  
Ref. No. 023864R

