



**Connells**

Deacon Place  
Middleton Milton Keynes



### Property Description

Nestled in the sought-after area of Middleton, this two-bedroom terraced home is offered with no upper chain, making it an ideal choice for first-time buyers, downsizers, or investors looking for a hassle-free move.

Step inside and you'll find a modern kitchen that flows into a living space, perfect for everyday life and entertaining. Upstairs, two well-proportioned bedrooms provide comfort and flexibility, complemented by a family bathroom. Outside, a low-maintenance garden offers a peaceful spot to relax, while the front aspect provides easy street parking.

Middleton is renowned for its community feel and excellent amenities. Families will appreciate being within walking distance of Middleton Primary School, secondary options such as Oakgrove School are also close by, making this a fantastic location for education.

Commuters will love the connectivity: regular bus services link you to Milton Keynes Central Station, where fast trains whisk you to London in under 40 minutes. Road links are equally convenient, with quick access to the M1 and A5 for journeys north or south.

For shopping and leisure, you're spoiled for choice. The centre:mk and Midsummer Place offer hundreds of stores, from high-street favourites to designer brands, plus a vibrant dining scene. Nearby retail parks and local conveniences ensure everything you need is within easy reach.

### Entrance Hall

Stairs rising to first floor,

### Kitchen

9' 9" x 5' 9" ( 2.97m x 1.75m )

A variety of wall and base units, plumbing for

a washing machine, space for a fridge/freezer, sink & drainer, gas hob with hood over, low level electric oven, glazed window to front aspect, tiled splashbacks, radiator.

### Downstairs Cloakroom

Wash hand basin, Low level WC, radiator.

### Lounge

17' 2" Max x 12' 8" Max ( 5.23m Max x 3.86m Max )

Doors and windows to rear garden, laminate floor, radiator, under stairs cupboard.

### First Floor Landing

Doors to all rooms.

### Bedroom One

10' 9" Max x 9' 1" ( 3.28m Max x 2.77m )

Glazed window to rear, carpeted flooring, radiator.

### Bedroom Two

12' 6" Max x 9' 7" Max ( 3.81m Max x 2.92m Max )

Carpeted flooring, radiator, glazed window to front, fitted wardrobe.

### Outside Space

#### Front Garden

Gravelled shrub bed, path to front door, external storage cupboard.

#### Rear Garden

Mainly gravelled, raised decking area, enclosed fencing.

### Parking

Allocated parking



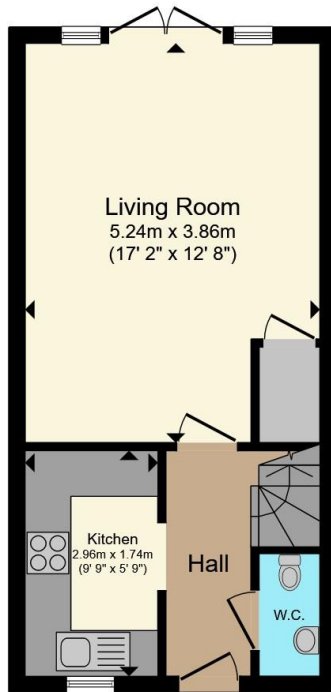

**Ground Floor**

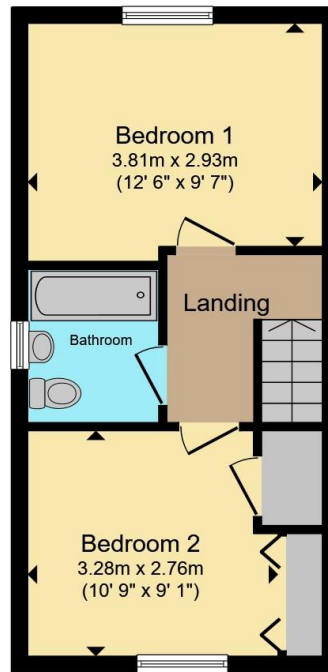

**First Floor**

Total floor area 64.1 m<sup>2</sup> (690 sq.ft.) approx

This floor plan is for illustrative purposes only. It is not drawn to scale. Any measurements, floor areas (including any total floor area), openings and orientation are approximate. No details are guaranteed, they cannot be relied upon for any purpose and they do not form part of any agreement. No liability is taken for any error, omission or misstatement. A party must rely upon its own inspection(s). Powered by [www.propertybox.io](http://www.propertybox.io)



To view this property please contact Connells on

**T 01908 691606**

**E [walnuttree@connells.co.uk](mailto:walnuttree@connells.co.uk)**

26A Fyfield Barrow The Walnut Tree Local Centre Walnut Tree

EPC Rating: C Council Tax Band: B

**view this property online [connells.co.uk/Property/WNT307970](http://connells.co.uk/Property/WNT307970)**

Tenure: Freehold



1. MONEY LAUNDERING REGULATIONS Intending purchasers will be asked to produce identification documentation at a later stage and we would ask for your co-operation in order that there will be no delay in agreeing the sale. 2. These particulars do not constitute part or all of an offer or contract. 3. The measurements indicated are supplied for guidance only and as such must be considered incorrect. Potential buyers are advised to recheck measurements before committing to any expense. 4. We have not tested any apparatus, equipment, fixtures, fittings or services and it is in the buyers interest to check the working condition of any appliances.

Connells Residential is registered in England and Wales under company number 1489613, Registered Office is Cumbria House, 16-20 Hockliffe Street, Leighton Buzzard, Bedfordshire, LU7 1GN. VAT Registration Number is 500 2481 05.

**See all our properties at [www.connells.co.uk](http://www.connells.co.uk) | [www.rightmove.co.uk](http://www.rightmove.co.uk) | [www.zoopla.co.uk](http://www.zoopla.co.uk)**

Property Ref: WNT307970 - 0003